



TOWN OF PORT HEDLAND

POLICY 11/008

DOMESTIC SATELLITE DISH POLICY

1. Introduction

The Town of Port Hedland is responsible for planning and building controls within its local government area. This policy has been formulated to provide residents and Council guidance on the installation of Domestic Satellite Dishes within the Town.

2. Purpose and Application of the Policy

2.1 Purpose

The purpose of the Policy is to provide development and building controls on the location, design and installation of Domestic Satellite Dishes.

2.2 Application

This Policy applies to all Domestic Satellite Dish Installations within the Town of Port Hedland.

3. Definitions

For the purposes of this Policy, the following definitions apply:

Domestic Satellite Dish Installation is defined as any equipment, fittings and structures associated with the receiving and/or transmitting of digital and analogue transmissions via satellite for domestic purposes, including television, Internet and audio transmissions.

Free-standing Installation is defined as any installation (including dish, fittings, footings and supports) of a Domestic Satellite Dish that is not structurally supported by another structure, such as a building, fence or other pre-existing structure.

Supported Installation is defined as any installation (including dish, fittings and supports) of a Domestic Satellite Dish that is structurally supported by another structure, such as a building, fence or other pre-existing structure and includes all roof-mounted installations.

4. Exemptions from this Policy

Any satellite dish to be installed for commercial purposes, including public viewing of domestic transmissions is exempt from this Policy. Council Planning and Building approvals are required for any satellite dish for commercial purposes prior to installation.

5. Policy Guidelines

5.1 Approvals

Subject to the location, size and engineering requirements contained in sections 5.2, 5.3 and 5.4 of this Policy, the following levels of Council Approval are required:

Type/Location of Installation	Level of Approval
Free-standing Installation behind front building line of the main house or building on the property.	No Planning or Building Approval required. See section 5.5 for registration requirements.
Free-standing Installation in front of the building line of the main house or building on the property.	Planning Approval only is required prior to installation. See section 5.5 for registration requirements.
Free-standing Installation that is higher than 300mm above the roof ridge of the main house or building on the property.	Planning Approval only is required prior to installation. See section 5.5 for registration requirements.
Supported Installation.	Planning and Building Approvals are required prior to installation.

5.2 Location of Installations

Side and rear boundary setbacks:

All Domestic Satellite Dish Installations are to be setback a minimum of 1.0m from side and rear property boundaries, unless specifically approved by Council.

Front boundary setbacks:

Where a Domestic Satellite Dish Installation is to be located in front of the building line of the main house or building on a property, the setback to the front boundary will be a minimum of 50% of the required building setback prescribed by Council's prevailing Town Planning Scheme and/or the Residential Design Codes for that particular property.

Setback calculation:

The setback distance shall be calculated from the property boundary to the nearest edge of the Installation, including the dish.

Service easements:

No Domestic Satellite Dish Installation is to be located within a service easement without the prior written approval of the authority responsible for the easement.

Responsibility for locating underground services:

The landowner is responsible for ensuring the location of a Domestic Satellite Dish Installation does not interfere with any underground services or effluent disposal systems.

5.3 *Size Limitations*

Notwithstanding the approval requirements of section 5.1 of this Policy, all Domestic Satellite Dish Installations with a diameter greater than 1.25 metres requires formal Planning and Building Approvals.

5.4 *Engineering Requirements*

Free-standing Installations:

Notwithstanding that Planning or Building Approval may not be required, all Free-standing Installations are to comply with minimum engineering specifications for Region 'D' cyclonic areas as certified by a practicing structural engineer.

Supported Installations:

All Supported Installations will require individual engineering certification that they meet Region 'D' cyclonic area requirement by a practicing structural engineer. Certification that the structure supporting the installation is appropriate for the task is required.

5.5 *Registering and Acknowledgement of Installations Not Requiring Council Approvals*

Where Planning or Building Approval is not required by this Policy, the landowner is to provide Council with a written confirmation that the Domestic Satellite Dish Installation meets the requirements of this Policy and minimum engineering requirements. Council will acknowledge the confirmation in writing and place it onto the property file for that property. A form for registering the dish is attached to this Policy.

5.6 *Non-compliant Installations*

If a property is found to have a Domestic Satellite Dish Installation that does not comply with this Policy or there is no written confirmation on file, Council will require the installation to be removed or formalised to the satisfaction of Council's Manager Building Services and Town Planner. Any formalisation must comply with all relevant provisions of this Policy.

Figure 1: Plan showing standard setback requirements for a Free-Standing Dish Installation.

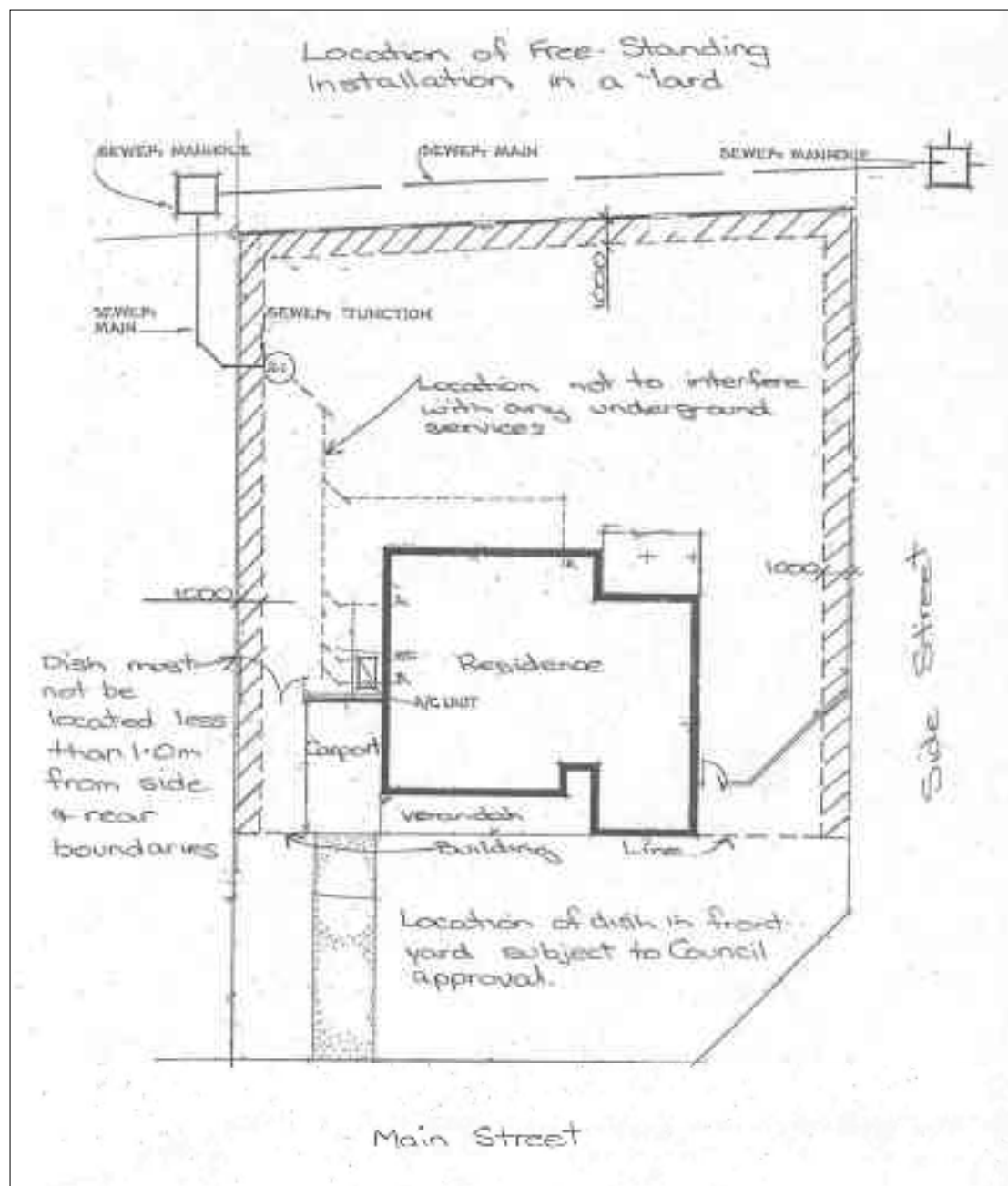



**REGISTRATION OF DOMESTIC SATELLITE DISH
COMPLIANT WITH TOWN OF PORT HEDLAND
DOMESTIC SATELLITE DISH POLICY (POLICY 11/008)**

PROPERTY DETAILS:

Lot: House Number: Street:

Suburb: Postcode:

PROPERTY OWNER DETAILS:

Surname: First Name(s):

Postal Address:

Contact Telephone:

PROPERTY OWNER DECLARATION:

I declare that:

1. I have installed or have had installed by a competent person a domestic satellite dish at the above property.
2. The domestic satellite dish as installed on my property is not structurally supported by another structure and/or fitted to a roof of a building on the property.
3. The domestic satellite dish as located on my property does not require specific Council Planning or Building approvals as stipulated in Part 5 of Council's *Domestic Satellite Dish Policy (Policy 11/008)*.
4. The domestic satellite dish as installed on my property meets minimum engineering specifications for Region 'D' cyclonic areas as certified by a practicing structural engineer.
5. The domestic satellite dish as installed on my property meets all relevant requirements of Council's *Domestic Satellite Dish Policy (Policy 11/008)*.

SIGNED: DATE:

OFFICE USE ONLY:

Date Lodged: File Number:

Date Registered on Assessment Record:

Date Response Sent: