



Company Overview

2014



INTRODUCTION

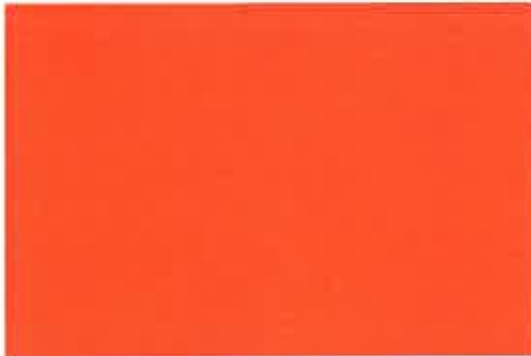

Introducing @leisure

@leisure is one of Australia's largest and leading **sport, leisure and open space** consultancies. We have been providing services to government, sports and the parks and land development industry for over 20 years.

We specialise in **planning and designing public spaces and facilities** to support active lifestyles and enhance leisure experiences.

We employ professionals from a range of disciplines including recreation, strategic and environmental planning, sports and project management, marketing, business, and landscape design. With its multidisciplinary team @leisure delivers a range of project types, including:

- Strategic plans for infrastructure and sport and recreation organisations
- Facility plans
- Feasibility studies and business cases
- Master plans and design projects
- Demand analyses
- Participation projections and market modelling
- Comprehensive stakeholder and community engagement programs

We are known for our consultative style, the ability to work co-operatively, rigorous methods and extensive research skills. Our community, staff and stakeholder engagement process is tailored to each individual project to ensure financial, social and environmental objectives are met.

We offer our clients the full range of skills needed to undertake projects efficiently, while providing the depth of knowledge necessary to ensure outcomes are practical to implement. By addressing the specific needs of key stakeholders and a wide range of user groups, we ensure that projects succeed on the ground.



SPECIALISTS IN

SPORT

- Feasibility studies and business cases
- Indoor and outdoor sport facility planning and design
- Strategic and business plans for sports organisations
- Demand projections and modelling
- Master plans and management plans
- Grounds management reviews
- Strategic Plans

RECREATION PLANNING AND PARTICIPATION

- Participation and activation strategies
- Community surveys and market research
- Access and inclusion
- Recreation strategies and needs assessments
- Community infrastructure planning
- Community and stakeholder engagement plans

OPEN SPACE

- Open space strategies
- Open space planning for new residential development and structure plans
- Peer reviews and expert witness statements
- Animal management plans and dog park designs
- GIS mapping and catchment analysis
- Master plans and designs
- Water based recreation plans

SKATE / BMX / MTB

- Skate / BMX / scooter / MTB strategic plans
- Youth facility strategies
- Facility audits, risk assessments, retrofits
- Management plans
- Design concepts

AQUATICS

- Aquatic feasibility and business cases
- Aquatic strategies and development plans
- Design input
- Business plans and management reviews
- Demand assessments and stakeholder engagement

TRAILS / CYCLING / WALKING

- Off-road trail strategies
- Off-road trail and path route-way planning
- Cycling, walking and equestrian strategies
- Off-road trails and path design



TRACK RECORD

"@leisure were required to complete the project in an extremely short time frame, placing pressure on the end product. They were able to complete the project in a professional manner, on time and involve the community in a manner that is the best I have seen in 23 years of local government."

Jenny Churchill, Co-ordinator Arts & Leisure, Bass Coast Shire Council (Skate and BMX Strategy, Open Space Strategy and Recreation Plan)

"The paper is a thorough, well-planned report ..."
Senior Environmental Planner, Department of Sustainability and Environment to the City of Casey Open Space Issues Paper

"Glenorchy City Council have utilised the services of @leisure over the past five years and in that time have developed a strong relationship with the company. Council has been impressed with the coordination of the projects and the methodology to produce both strategic and practical documents that our staff and our community continue to use as a reference."

The documents have provided strong strategic direction and influenced the priorities for ongoing capital works. This has supported external funding applications and assisted communication with our elected members. Glenorchy City Council will continue to consider @leisure for consultancy projects in our City." Rod Marshall, Property & Recreation Co-ordinator, Glenorchy City Council

"It has been terrific working on this project with you guys, I have really enjoyed it and your pleasant customer service towards Council has really been noted. I sincerely thank you." Troy Scoble, Recreation Development Coordinator, Moorabool Shire Council (Bacchus Marsh Racecourse Reserve Master Plan)

"@leisure continually demonstrates a desire to make a difference through recreation. This came through loud and clear during our project." Dale Stewart, Leisure Management & Sports Planning Officer, City of Melbourne, Recreation and Leisure Plan Project Holland Park Risk Assessment, Rectification, Redesign, Docklands Skate Facility Feasibility

"The final reports went to Council last week and the feedback from Councillors has been excellent. People are very impressed with the report and how smoothly this project has progressed. I have thoroughly enjoyed working with you and appreciated your professional approach. Meetings were always handled with due care and you have helped make my job an enjoyable and satisfying one." Liz Wood, Senior Project Officer, City of Greater Geelong (Eastern Park and Geelong Botanical Gardens Master Plan, in conjunction with Hansen Partnership)

"Thanks again for all your hard work, patience, co-operation and good working relationship. It has been a pleasure to do business with all the staff at @leisure." Lew Wilson, Recreation Development Officer, South Gippsland Shire Council (Open Space Plan and Recreation Strategy)

"The report provided by @leisure was excellent, as was the consultation process undertaken. It was the best report I have read in my 10-years-as-a Councillor." Councillor Ian Beales, Murrindindi Shire Council (Sports Reserves Master Plans)

"The Smiths Beachcomber Association wishes to congratulate the Bass Coast Shire Council and its officers for commissioning this well-researched, far-reaching and comprehensive report." Ian Shand, Smiths Beachcomber Association, Bass Coast Shire (Open Space Strategy)

"I want to compliment @leisure on the excellent strategic recreational planning service which you provide. The reports you have prepared have been 1st class and the community consultation processes and industry experience @leisure bring to the table are extremely valuable. It was certainly worth contracting @leisure who enabled our Council to sort through complex problems and to find appropriate solutions. As a result, Council is now well equipped to tackle the multiple challenges that face the Council. I would recommend @leisure to others who are seeking someone who really understands the complex issues which confront communities both short term and long term." Craig Halley, Leisure Services Coordinator, Southern Grampians Shire Council, Aquatic Facility Development Strategy & Technical Assessment, Hamilton Hockey Feasibility, Tennis Development Strategy and Paterson Park Master Plan

"I was impressed with how inclusive it is ... it looks great. We do appreciate that you have put a lot of time into the strategy, and more than originally anticipated; thanks for that." Anthony Nelson East Gippsland Shire (East Gippsland Shire Trails Strategy)

As a small rural local government area, @leisure have provided the highest quality of service to us. Their expertise in consulting with small communities and the larger residential pockets of our municipality has ensured that all voices are heard and has moved Council in the right direction to assist our communities to strengthen and develop. @leisure have a dedicated in-house team of staff that make it a pleasure to work with in-person, over the phone and via the internet. Their ability to rely on their professional networks to assist in the development of technical plans and reports has meant that we have received high quality and personal attention from all of the @leisure staff."

Ros Young (Former) Recreation Officer, Shire of Murrindindi (Recreation Reserves and Play Strategy)

RELEVANT PROJECT EXPERIENCE

Sports Master / Concept Plans

Albert Park Master Plan - Parks Victoria (in progress)

Toorak Park Precinct Plan - City of Stonnington

Newman Recreation Master Plan - Shire of East Pilbara

Boronia Road Sports Facilities Concept Plan -
City of Whitehorse

Bairnsdale Sport and Recreation Precinct Master Plan -
East Gippsland Shire Council

Debneys Park Master Plan - City of Moonee Valley

CB Smith Reserve Synthetic Soccer Facility - Site Evaluation -
City of Moreland

King George V Precinct Master Plan Update -
Glenorchy City Council

Shepparton Sports Precinct Design Concept -
City of Greater Shepparton

Bulgarrá Public Open Space Master Plan - Shire of Roebourne

Coburg City Oval Reconfiguration Options - City of Moreland

Torquay North Civic Community Precinct Master Plan -
Surf Coast Shire

Bass Recreation Reserve Master Plan - Bass Coast Shire Council

Soccer and Croquet Field Site Selection and Concept Plan -
East Gippsland Shire Council

Hillview Reserve Dromana BMX and Mountain Bike Park -
Mornington Peninsula Shire Council

Bennettswood North Reserve Concept Plan and Management
Plan - City of Whitehorse

Hazelwood North Sports Facility Due Diligence -
Latrobe City Council

Woolamai Racecourse Recreation Reserve Master Plan -
Bass Coast Shire Council

Dial Regional Sports Complex Master Plan -
Sport and Recreation Tasmania

Regional Aquatic and Netball Precinct Master Plan -
Yarra Ranges Shire

Bacchus Marsh Racecourse Reserve Master Plan -
Harness Racing Victoria and Moorabool Shire Council

Cricket Centre of Excellence - City of Kingston

Cowes Recreation Reserve Master Plan -
Bass Coast Shire Council

Wonthaggi Recreation Reserve Master Plan -
Surf Coast Shire Council

Torquay Civic Community Sports Facility Implementation -
Surf Coast Shire Council

Coronet Bay Sports Plan Review - Bass Coast Shire Council

Collinsvale Recreation Reserves Master Plan -
Glenorchy City Council

Yarralumba Bay Foreshore Master Plan -
ACT Government Territory and Municipal Services

Fred Gratton Reserve Master Plan - Bass Coast Shire Council

Nyora Recreation Reserve Strategic Master Plan -
South Gippsland Shire Council

King George V Sports Facility Redevelopment (KGV) -
Glenorchy City Council

Yackandandah Sports Park Master Plan - Indigo Shire Council

Athletics Centre Master Plan - City of Moonee Valley



RELEVANT PROJECT EXPERIENCE

Sports Facility Plans and Strategies

Indoor Netball Centre Site Selection and Concept Design -
City of Stonnington

Future Directions - Soccer Plan - City of Moonee Valley

Best Value Review - Sportsground Allocation and
Management - Ryde City Council

Sports Demand Analysis - Maitland City Council

Active Sports Strategy Review -
Mornington Peninsula Shire Council

Tennis Facility Strategy - City of Kingston

Sport 2050 Strategic Plan - City of Greater Shepparton

Tennis Surfaces Strategic Advice -
Mornington Peninsula Shire Council

Sporting Pavilion Core Provision Elements -
Mornington Peninsula Shire Council

NSROC Sportsground Management Plan -
North Sydney Regional Organisation of Councils (NSROC)

Sportsground Management Strategy - Penrith City Council

North and West Metropolitan Regional Tennis Strategy -
Tennis Victoria

Aquatic Facility Development Strategy and Strategic Technical
Assessment - Southern Grampians Shire Council

Tennis Development Plan - Southern Grampians Shire Council

Tennis Facility Development Update -
Mornington Peninsula Shire Council

Soccer Development Plan -
Mornington Peninsula Shire Council

Badminton Victoria Strategic Plan - Badminton Victoria

Sportsground Allocation Procedure and Pricing Policy -
City of Boroondara

Golf Driving Range Demographic and Needs Analysis -
Sport & Recreation Victoria

Tennis Facility Development Plan -
Mornington Peninsula Shire Council

Victorian Tennis Participation Study - Tennis Victoria

MRC Recreation Study Impact Assessment -
Melbourne Racing Club

Pacific Mini Games 2009 Venues Plan -
Cook Islands Government

Victorian Ice Sports Strategic Plan -
Sport & Recreation Victoria

Municipal Tennis Strategy - City of Moonee Valley

Sports Field Activity Audit - City of Whitehorse

Cricket and Football Strategy - City of Whittlesea

Equestrian Industry Study - Sport & Recreation Victoria

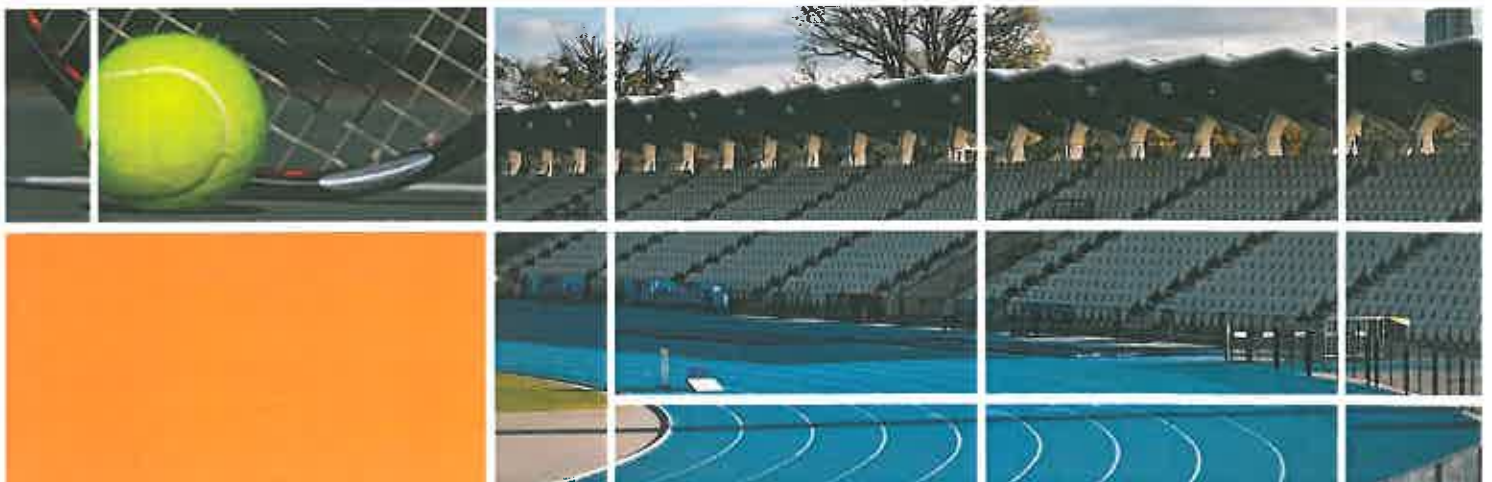

RELEVANT PROJECT EXPERIENCE

Open Space Planning for New Residential Developments

Murrumbateman Structure Plan - Open Space and Recreation Plan - Yass Valley Council

Shepparton North East Growth Corridor Open Space Plan - Greater Shepparton City Council

Clyde North Precinct Structure Plan - Open Space Evidence - City of Casey

Cranbourne North PSP - Open Space Peer Review - Growth Areas Authority

Spring Creek Growth Areas Plan - Open Space Plan - Surf Coast Shire

Review of Open Space in South Laverton - City of Hobsons Bay

Doveton / Eumemmerring Precinct - Open Space Review of School Sites - City of Casey

Shepparton South East Growth Corridor Development - Open Space and Recreation Plan - Greater Shepparton City Council

North Carlton Public Housing Estate Redevelopment - Open Space Expert Witness - Department of Human Services

Cotter Dam Precinct, Recreation and Open Space Planning Input - ACTEW

Kilmore Structure Plan - Open Space Review - Mitchell Shire Council

Wallan Structure Plan - Open Space Review - Mitchell Shire Council

Lawrence Road Subdivision, Yea, Open Space Review - Murrindindi Shire Council

Knox Central Urban Design Framework: Open Space Assessment - Hansen Partnership

Open Space and Peer Reviews and Expert Witness Statements

Review of Provision of Open Space Proposed at 105 Smiths Lane (as part of Thompsons Rd Precinct Structure Plan) - Beveridge Williams

Open Space Plan Peer Review and Forum - City of Bayside

Open Space Needs Analysis - City of Maroondah

Assessment of the Value and Future Use of Nancarrow Park Kerang - Shire of Gannawarra

Murrumbateman Structure Plan - Open Space and Recreation Plan - Yass Valley Council

The case for a New Regional Park in Casey - City of Casey

Design of a Public Park at Caulfield Racecourse - Melbourne Racing Club

Input into Growth Area Planning Framework: Unstructured Open Space - City of Casey

Olympic Park Reserve Review - Mornington Peninsula

C21 Planning Amendment - Open Space Planning and Input - City of Casey

Cotter Dam Precinct, Environmental Impact Assessment (Recreation Component in conjunction with GHD) - ACTEW

Leisure, Open Space, Playgrounds and Skate Workshops - City of Stirling

Public Toilet Strategy Review - Shire of Yarra Ranges

Feasibility of Fregon Reserve Land Swap - Monash Medical Centre and City of Monash

Hilledge Lane Reserve, Assessment of Development Proposal - Shire of Yarra Ranges

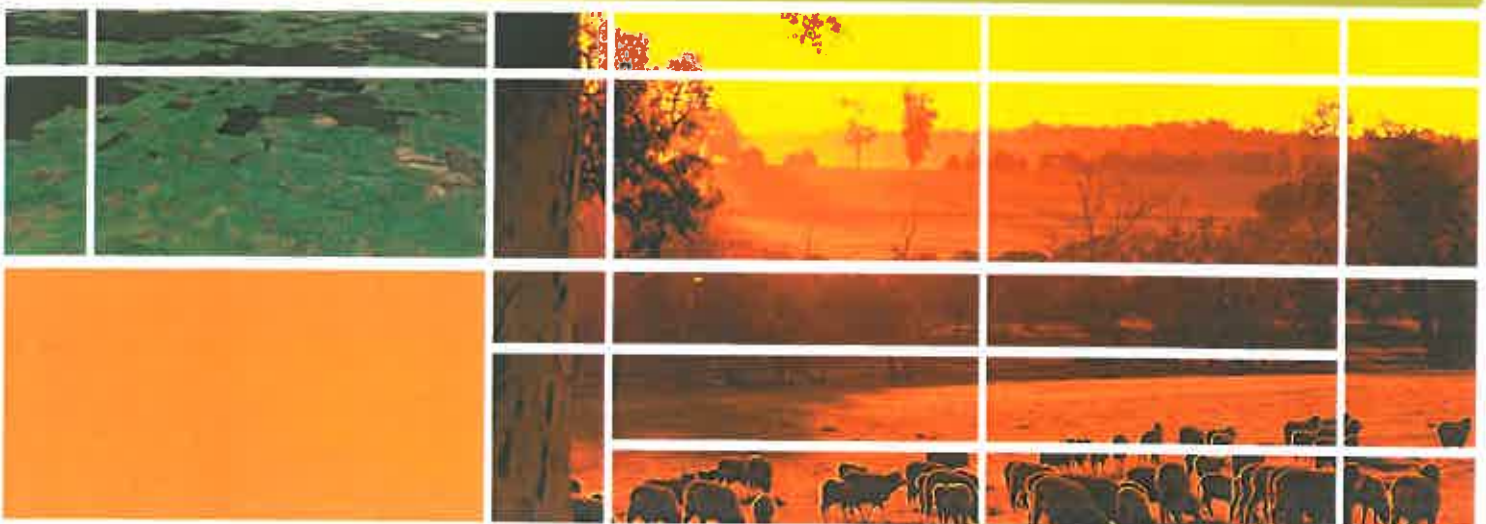

RELEVANT PROJECT EXPERIENCE

Sports Feasibility and Business Cases

Collingwood College Basketball Centre Business Case
Collingwood Basketball Association

Gippsland Regional Sporting Complex Feasibility and Master Plan Stage 2 - **Wellington Shire Council**

Tweed Regional Sports Facility Feasibility & Design Stage 2 (indoor and outdoor) - **Tweed Shire Council**

Regional Soccer Hub Feasibility, (indoor and outdoor) Concept and Business Plan (indoor and outdoor)
City of Greater Dandenong

Regional Indoor Hockey Facility Feasibility - **City of Banyule**

Municipal Cycle Sports Facility Feasibility - **City of Moreland**

Kununurra Leisure, Aquatic and Sport Facility Business Case
Shire of Wyndham East Kimberley

Multi-sport Synthetic Field Feasibility Study
Glenelg Shire Council

Alexandra Community Leisure Centre Redevelopment Feasibility Study - **Murrindindi Shire Council**

Synthetic Hockey Facility Feasibility - **Gannawarra Shire Council**

Nyora Community Facility Feasibility and Scoping Study
Nyora Recreation Reserve CoM

Preston City Oval Sport Facility Feasibility - **City of Darebin**

Yea Swimming Pool Redevelopment Feasibility
Murrindindi Shire Council

Regional Aquatic and Netball Feasibility and Master Plan
Yarra Ranges Shire

Synthetic Hockey Facility Feasibility
Southern Grampians Shire Council and Glenelg Regional Hockey Association

Synthetic Hockey and Soccer Field Feasibility
North Sydney Council

Premier Soccer Stadium Feasibility - **City of Darebin**

Indoor Sports and Aquatic Centre Feasibility
Narrabri Shire Council

Launceston Regional Tennis Facility Feasibility
Tennis Tasmania and City of Launceston

AAK Gymnastics Feasibility and Business Plan
Varsity Gymnastics

Alexandra Showgrounds Multi Purpose Centre Feasibility
Murrindindi Shire Council

Gymnastics Development Plan / Feasibility
City of Warrnambool

Gymnastics Feasibility Study - **City of Whitehorse**

Gymnastics Facility Feasibility Study
City of Greater Shepparton

Aquatic and Leisure Centre Expansion Feasibility Study
City of Hurstville

Synthetic Hockey Feasibility Study
Macquarie University Sports Association

Officer Farm Open Space Master Plan and Sports Feasibility Study - **Jennings**

Premier Soccer Stadium Feasibility - **City of Hobsons Bay**

Chirnside Park Netball Court Feasibility - **Yarra Ranges Shire**

Williamstown Town Hall Redevelopment Feasibility
City of Hobsons Bay



RELEVANT PROJECT EXPERIENCE

Recreation Strategies

Open Space Recreational Needs Assessment - **Mosman Council (in progress)**

Recreation Facilities Strategy - **City of Canada Bay**

Recreation Strategy - **Bayside City Council**

Sport, Recreation and Activity Strategy - **City of Rockingham**

Active Women and Girls Strategy - **City of Moreland**

Recreation Plan - **Bass Coast Shire Council**

Recreation Plan - **Glenorchy City Council (TAS)**

Recreation Study Impact Assessment - **Melbourne Racing Club**

Recreation Asset Management Plan - **Gannawarra Shire Council**

Recreation Strategy Plan - **South Gippsland Shire Council**

Municipal Recreation Plan - **Indigo Shire Council**

Leisure Needs in M2030 Activity Centres - **City of Kingston**

Recreation Plan - **City of Newcastle**

Melbourne Recreation and Leisure (Active Melbourne) Strategy - **City of Melbourne**

Kensington Recreation Needs Study - **City of Melbourne**

Regional Recreation and Sports Strategy - **City of Albury**

Strategic Leisure Services Action Plan - **City of Darebin**

Leisure Strategy - **City of Casey**

Leisure Choices for Older Adults - **City of Kingston**

Recreation Needs Study Review - **Alpine Shire Council**

Recreation and Open Space Study - **City of Brimbank**

Open Space Strategies

Nilumbik Recreation Study - **Shire of Nilumbik**

Integrated Open Space Strategy - **The Hills Shire Council**

Open Space Strategy - **Macedon Ranges Shire Council**

Play Spaces Strategy - **Launceston City Council**

Open Space Strategy - **Mitchell Shire Council**

Casey Open Space Strategy - **City of Casey**

Open Space Plan - **Maitland City Council**

Moreland Open Space Strategy Finalisation - **City of Moreland**

Open Space Strategy - **City of Wyndham**

Open Space Planning Advice - **Department of Planning and Community Development**

Open Space Plan - **Central Coast Council**

Cradle Coast Regional Open Space Plan - **Cradle Coast Regional Authority (Received a Planning Award - Certificate of Recognition)**

Open Space Strategy - **South Gippsland Shire Council**

Active City Strategy M2030 - **Sport & Recreation Victoria**

Open Space Strategy Review - **City of MaroonDAH**

Open Space Strategy - **City of Kingston**

Coffs Harbour Recreational Open Space Plan - **Coffs Harbour City Council**

Open Space Strategy - **City of Hobsons Bay**

Open Space Strategy - **City of Port Phillip**

Open Space Plan - **City of Newcastle**



RELEVANT PROJECT EXPERIENCE

Sport Management Plans, Pricing & Occupancy Agreements

Best Value Review – Sportsground management and allocation - City of Ryde

Sportsground Management Strategy - Penrith City Council

Sportsground Management Plan - Northern Sydney Regional Organisation of Councils (NSROC)

Boroondara Sportsground Allocation and Pricing Policy Review - City of Boroondara

Fees and Charges Review - City of Albury

Leases and Licenses Policy Review - Glenorchy City Council

Sports Policy - City of Newcastle

Sportsground Allocation Procedure and Pricing Policy - City of Boroondara

Review of Committees of Management - Murrindindi Shire Council

No. 1 Sportsground Lease and Sports Occupancy Agreements - City of Newcastle

Review of Committee and Occupancy Agreements - City of Glen Eira

Standard Licence Agreements for Specific Sports Codes - City of Moreland

Sportsground Pricing Policy - Parks and Leisure Australia

Review of Sports Fees and Charges Policy - Kingborough Council

Sports and Community Fees and Charges Policy - City of Moreland

Review of Occupancy Agreements for all Community Facilities - City of Moreland

Sports Administration and Fees Review - City of Whitehorse

Pricing Seminar - Mornington Peninsula Shire Council

Sports Fees and Charges Policy - Manningham City Council

Review of Leases & Use Agreements for Community Tennis Facilities - City of Melbourne

Review of the Rowing Occupancy Agreements - City of Melbourne

Review of all Tennis and Lawn Bowls Clubs Occupancy Agreements - City of Melbourne

Crown Land Rental Policy - City of Melbourne



RELEVANT PROJECT EXPERIENCE

Cycle and Trail Strategies

Identification and Audit of Regional Trails -
Moira Shire Council

Recreation Trails Strategy and Guidelines -
Mitchell Shire Council

Moreland Cycle Sport Feasibility - City of Moreland

Trails Strategy and Guidelines - East Gippsland Shire Council

Whitehorse Open Space and Bicycle Plan Project Brief -
City of Whitehorse

Regional Equestrian Trails Strategy -
City of Casey and Shire of Cardinia

Docklands Skate Routeways and Trails Strategy -
Dockland Authority

Dandenong Creek Trail Strategy -
Department of Planning and Environment

Warburton Rail Trail Development Plan - Shire of Lilydale

Strategy and Route Way Planning (route planning as part of open space)

Open Space Strategy - Shire of Macedon Ranges

Recreation Strategy - Bayside City Council

Open Space Strategy - Wyndham City Council

Open Space Strategy - Maitland City Council

Open Space Strategy - City of Maroondah

Open Space Plan Implementation - Maribyrnong City Council

Open Space Strategy - City of Casey

Clyde North Precinct Structure Plan - City of Casey

Shepparton North East Growth Corridor - City of Casey

Yarra Bend Park - Dog Friendly Park - Parks Victoria

Spring Creek Growth Area Framework -
Open Space and Recreation Elements

Cranbourne East Precinct Structure Plan Open Space Peer
Review - Growth Area Authority

Clyde North Precinct Structure Plan - City of Casey

Officer Structure Plan - Open Space and Off Road Trails -
Shire of Cardinia

Laverton South Open Space Evaluation -
City of Hobsons Bay

Kilmore structure plan review - Open Space Elements -
Shire of Mitchell

Wallan Structure Plan Review - Shire of Mitchell

Yarra Bend Dog Friendly Park Guidelines (including the
Yarra Trail) - Parks Victoria

Yarrawonga to Bundalong Foreshore Master Plan (in
conjunction with Coomes Consulting) -
Moira Shire Council & Goulburn Murray Water

Active Moreland Women's and Girls Strategy -
City of Moreland

Central Coast Open Space Plan - Central Coast Council

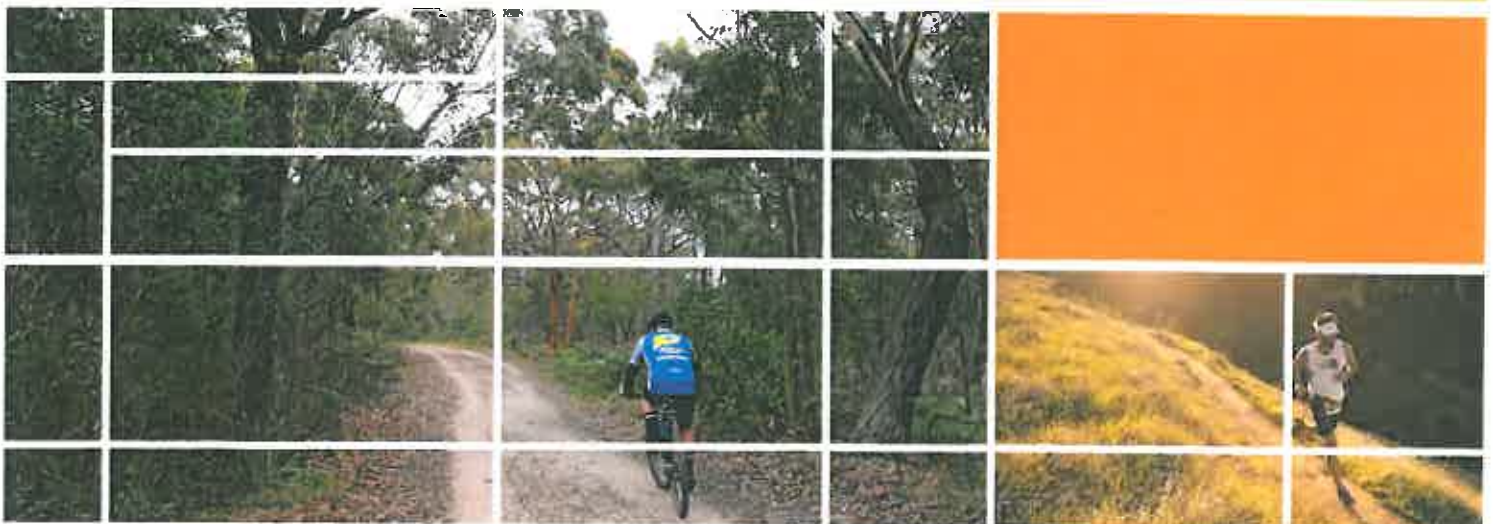

RELEVANT PROJECT EXPERIENCE

BMX and Skate Planning

Bicentennial Park Regional Skate Park Design Concept -
City of Kingston

Craigieburn Gardens BMX Track and Dirt Jumps Design Concept -
City of Hume

Holland Park BMX Dirt Jumps - Risk Management Works -
City of Melbourne

Holland Park: BMX Redesign and Management Plan - Stage 2 -
City of Melbourne

Harold Reid Reserve BMX Track Concept Plan -
Mornington Peninsula Shire Council

Hillview Reserve Dromana BMX and Mountain Bike Park Master
Plan - **Mornington Peninsula Shire Council**

Park Orchards BMX Track Risk Assessment -
Manningham City Council

Risk Assessment of all Skate and BMX Parks -
Mitchell Shire Council

Risk Assessment of Skate and BMX Facilities: Risk Management
Series for Councils - **Civic Mutual Plus**

Thorpdale BMX Track Planning - **Baw Baw Shire Council**

Western Reserve BMX Track Design -
Mount Alexander Shire Council

Assessment and Re-Design of Deanswood BMX Dirt Jumps -
Mornington Peninsula Shire Council

BMX Track Design Coronet Bay - **Bass Coast Shire Council**

Dromana BMX Site Assessment -
Mornington Peninsula Shire Council

Yea BMX Track: Planning Advice - **Murrindindi Shire Council**

Seminar: Skate and BMX Management -
Parks and Leisure Association

Skate and BMX Maintenance Checklists and Dirt Jumps Policy -
Mornington Peninsula Shire Council

Woody Yaloak Skate & BMX Track Planning -
Golden Plains Shire Council

Redesign of Brookland Green BMX Track - **City of Casey**

Unstructured Recreation Plan: Skate and BMX -
Hornsby Shire Council

Review of Woody Yaloak BMX Dirt Jump Design and Inspection -
Checklist - **Golden Plains Shire Council**

Skate and BMX Facility Management Plan and Maintenance -
Checklists - **City of Maroondah**

Skate and BMX Strategy and Management Plans -
City of Maroondah

East Burwood Reserve Mountain Bike Track Design -
City of Whitehorse

Community Youth Activity Nodes - **Shire of Melton**

Elsternwick Skate and Bowls Rectification Work - **City of Bayside**

Sandringham BMX Site Selection and Dirt Jumps Design -
City of Bayside

Bayside Dirt Jumps Area Planning and Management -
City of Bayside

Hill 'n' Dale BMX Park Risk Assessment and Management Plan -
City of Boroondara

Hill 'n' Dale Reserve Risk Assessment -
ASPECT Melbourne Pty Ltd

Peer Review and Retrofit: Hill 'n' Dale BMX Track -
City of Boroondara

Preparation of Hill 'n' Dale BMX Track, Site Inspection Checklist -
City of Boroondara



RELEVANT PROJECT EXPERIENCE

Aquatic Feasibility and Facility Projects

Newman Recreation Facilities Master Plan (including aquatic facilities) - Shire of East Pilbara

Business Case and Concept for a Kununurra Aquatic and Leisure Facility - Shire of Wyndham East Kimberley

Business Case and Feasibility – Tweed Regional Sports Centre (including aquatic centre) - Tweed Shire Council

Business and Marketing Plan for a new Aquatic Centre - Orange City Council

Regional Aquatic and Netball Precinct Feasibility and Master plan - Yarra Ranges Shire

Aquatic Facility Development Strategy and Strategic Technical Assessment - Southern Grampians Shire Council

Yea Swimming Pool Redevelopment Feasibility - Murrindindi Shire Council

Aquatic Facilities Contract Specifications - Glenelg Shire Council

Indoor Sports and Aquatic Centre Feasibility - Narrabri Shire Council

Marketing Strategy - Life Saving Victoria

Aquatic Centre and Gym Expansion Feasibility Study - Hurstville City Council

Swimming Pool & Leisure Facility Recurrent Cost Analysis - Orange City Council

Indoor Sport and Recreation Facility and Feasibility Study - Gungahlin Development Authority

Aquatics Strategy - City of Newcastle

Alexandra & Yea Aquatic Facilities Development Plan & SRV Submission - Murrindindi Shire Council

Torquay Recreation & Cultural Facility Feasibility Study - Surf Coast Shire

Specification for Altona & Laverton Aquatic Centres - City of Hobsons Bay

Market Assessment, Redevelopment & Coordination of the Planning & Design of the North Melbourne Swimming Pool - City of Melbourne

Specification for the Management of Queens Park Pool - City of Moonee Valley

Service Reviews for the City Baths & Carlton Baths - City of Melbourne

The Benefits of Indoor Recreation & Aquatic Centres - Parks & Leisure Australia

Evaluation of Tenders for the Wodonga Leisure Centre - City of Wodonga

Indoor Sports Court & Learn-to-Swim Facility Feasibility - City of Knox

Aquatic Leisure Centre Feasibility - Rural City of Swan Hill



WHO WE ARE

Sally Jeavons

Principal Planner

- Grad Dip Market Modelling, Swinburne U.T.
- Grad Dip Recreation Planning, Canberra CAE
- BA (Geography), University Of New England

Sally has 30 years experience as a recreation planner and twenty years as a director of @leisure. She has held board positions on international leisure associations over many years. She has managed local government recreation departments and has worked as an employee of in-state government in planning, recreation and housing departments.

Sally has undertaken extensive work in market research, community engagement, open space planning methodology, facility, sports facility planning and feasibility management and design, as well access and inclusion.

She has presented and published papers widely. Sally is a life member of Play Australia, and Parks and Leisure Australia. She was the recipient of the 2009 Frank Stewart Award for excellence and outstanding contribution to the field.

Sally is typically involved in all stages of the work and methodological aspects of projects as well as overall performance of each study team.



Jeremy Addison

Senior Strategic Planner

- Diploma in Project Management, Australian Institute of Management
- Grad Dip Urban and Regional Planning, Queensland University of Technology
- Bachelor of Applied Science (Rural Technology)

Jeremy has 22 years experience in strategic and statutory planning and policy development in a diverse range of projects, and in state and local government. His passion is for the development of viable and inclusive communities, which retain the environmental, social and economic values that make them unique.

Jeremy's experience in open space and recreation planning includes preparation of structure plans and local area plans, demographic and demand analysis, and assessment of open space supply and provision as part of development proposals. Jeremy also has accomplished project management and communication skills and the ability to engage people of all levels in a variety of settings.

Jeremy's role at @leisure is to project manage and prepare Open Space and Recreation Strategies, as well as providing strategic planning input on other projects.

Ross Parkhill

Business and Project Manager

- Masters of Engineering and Management, University of Strathclyde, United Kingdom

Ross is a qualified business analyst and PRINCE2 project manager who has experience working in a diverse range of industries both here and in the UK.

Ross's experience includes successfully managing challenging projects across different business sectors involving multiple stakeholders and external vendors, delivering to both tight timescales and budgets.

Ross is an active sports participant and has coached both senior and junior soccer teams. His hands on experience in sports business includes setting up a soccer club's junior programme and managing a fundraising initiative for club development.

Ross's role at @leisure includes testing the feasibility of facilities and preparing financial forecasts, as well as managing projects throughout their lifecycle. Internally he is responsible for financial management, systems development and business growth.



WHO WE ARE

Glen Holschier

Open Space and Recreation Planner

- Bachelor of Resource and Environmental Planning (Hons), Massey University (New Zealand)

Glen brings seven years experience as an open space planner in New Zealand, United Kingdom and Australia for both local government and private practice.

He has been involved in a range of open space, statutory, strategic and recreation projects and is particularly experienced in the preparation of open space and recreation strategies. Most recently Glen has been involved in developing open space strategies for Mitchell Shire, Macedon Ranges Shire and Moreland City, undertaken master planning projects for Shire of East Pilbara (WA) and Wellington Shire, and has prepared other recreation related projects for the City of Melbourne, Moira Shire and Launceston City (TAS).

Glen's primary role at @leisure is to prepare open space and recreation related strategies, including providing assessments of demand and demographics, consultation, and supply. Glen has the ability to maintain GIS layers and produce mapping of open space and recreation facilities through Mapinfo Professional.



Matt Priem

Sports Business Planner

- Master of Business (Sport Management) (Due for completion 2015) Deakin University
- Bachelor of Arts (Media Communications), Deakin University
- Bachelor of Commerce (Marketing), Deakin University

Matt's role at @leisure includes managing community engagement processes, analysing trends and demand, preparing projections for participation and usage of facilities and social media. He is also responsible for project management and administration.

His experience includes considerable market analysis and research and digital media. Matt is currently studying Sport Management and is an active sports participant. Matthew has great analytical and communication skills and a breadth of experience in a wide range of social technology processes and digital marketing techniques.

Prior to joining @leisure, Matt worked for the Mimosa Studio Project (a Red Cross subsidiary) as a Social Media Assistant, was a Developer for a company called FantasyPay. He has worked as an Online Community Manager for PlayUp Australia and as a Business Analyst at Dun and Bradstreet.



Ben Bunting

Senior Sport and Recreation Planner

- Bachelor of Social Sciences (Geography/Planning) University of Waikato (New Zealand)
- Master of Sciences (Earth Sciences/Resource and Environmental Planning), University of Waikato (New Zealand)
- Postgraduate studies in Parks, Recreation and Tourism Management, Lincoln University (New Zealand)

Ben has 16 years of experience in recreation, tourism and open space planning in local and state government in Victoria, Queensland and New Zealand.

Ben's expertise includes sports and recreation participation analysis, developing sport and recreation plans and strategies, developing recreation and tourism opportunities on public land, land use planning for sport and recreation and comprehensive project management.

Ben has previously held senior recreation roles in the Victorian departments of Sustainability and Environment, Planning and Community Development, Sport and Recreation Victoria, Parks Victoria and Wyndham City Council.

Ben also prepares and delivers expert evidence at planning hearings in relation to land use planning for sport and recreation, and is a member of Parks and Leisure Australia and the Planning Institute of Australia.



CORPORATE INFORMATION

Memberships and Affiliations

- Parks and Leisure Australia
- Play Australia
- The Sports and Play Construction Association
- Aquatic Recreation Victoria
- Australian Leisure Facilities Association
- Victorian Planning and Environmental Law Association (VPELA)
- Australian and New Zealand Leisure Studies Association
- Australian Consultants in Access: Australia
- Institute of Public Works Engineering Australia
- Association of Children with a Disability

Insurance and Statutory Requirements

@leisure Planners Pty Ltd currently has:

<i>Insurance policy:</i>	<i>Company:</i>	<i>Policy #:</i>	<i>Policy value:</i>
Public Liability	QBE Insurance	141A5841568PK	\$20 million
Public Indemnity	Lloyds, London	03P11002947/34	\$5 million each and every Claim
Workcover	CGU	12945124	Full cover

@leisure Planners Pty Ltd
ABN: 87 137 748 636

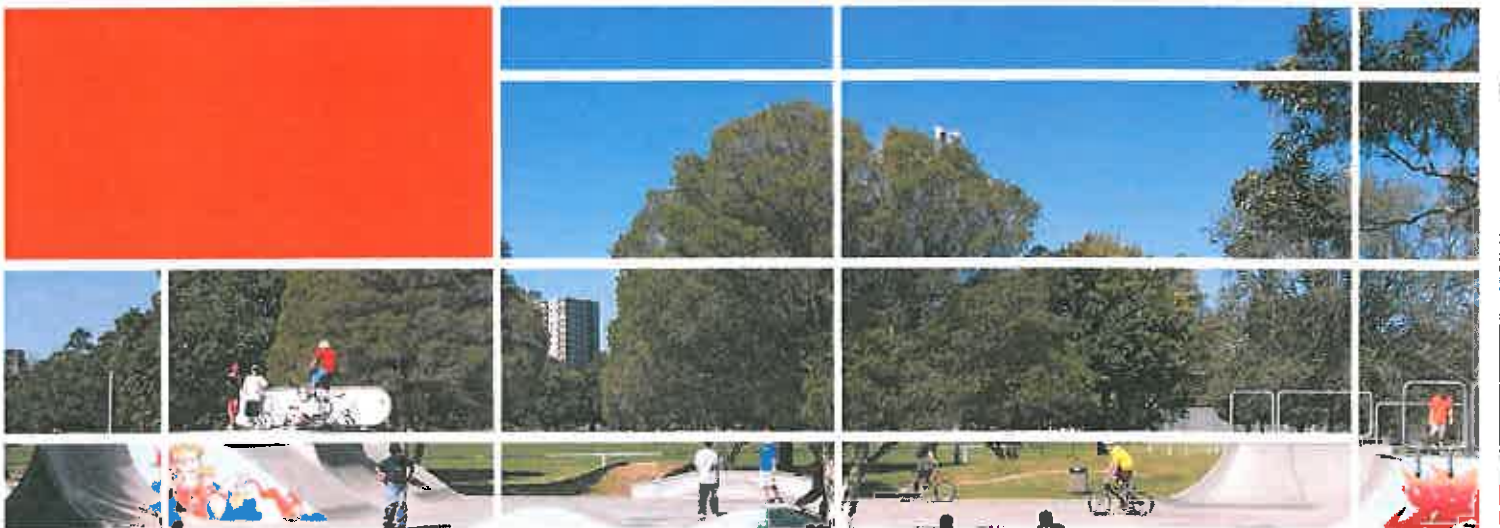

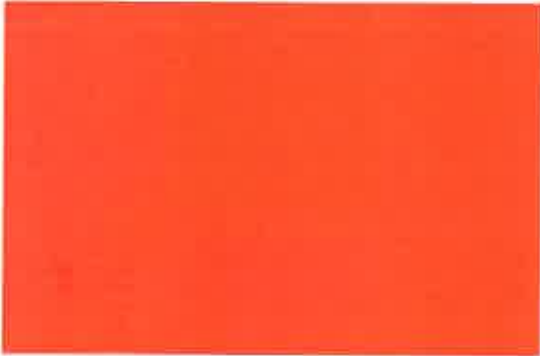

leisure PLANNERS

Rear 534
Mt Alexander Road
Ascot Vale
VIC 3032 Australia
(03) 9326 1662
info@atleisure.com.au
www.atleisure.com.au

 @leisure Planners

 atleisure_au

COMPANY PROFILE

MacroPlan Dimasi provides innovative and strategic advice on significant projects that contribute to the evolution and changing face of Australia's landscape. We understand that the economic, property and planning environment is ever-changing and that no two projects are the same.

We provide a customised assembly of services and staff to minimise project risk and work with our clients to deliver precise solutions tailored to individual needs for projects of all scales and locations.

With 75 staff working in offices in Melbourne, Sydney, Perth, Brisbane and the Gold Coast, MacroPlan Dimasi has a national footprint working across Australia, New Zealand, Asia and the Middle East.

We offer an expanded range of services across all property sectors. With almost three decades of project experience and an average of 1000 projects per year, we will provide you with an accurate and clear perspective so that you can make more informed decisions.

Our in house economists, urban designers, planners, spatial demographers, GIS specialist, market researchers and community specialists offer unparalleled depth and breadth of expertise in understanding the macro and micro drivers of development.

This provides our clients with unique insights into the changing nature of business investment in a post-GFC environment, key domestic and international investment signals and emerging demographic and economic trends which will influence long-term growth.

Economics: Our experienced team of senior economists, consultants and analysts utilise the latest information, technology and statistical applications to bring you the most accurate economic analysis.

Planning and Design: MacroPlan Dimasi offers a range of planning and design services from strategic assessment, urban redevelopment, conceptual design and critique and place activation through to policy formulation, development approvals and project implementation.

Spatial Analysis: MacroPlan Dimasi has expertise in the use of GIS as a business analysis tool to map and analyse the factors impacting the current or future performance of development and the potential demand for services or facilities.

Research: Utilising our 30 plus year databases, linked to our GIS capabilities, MacroPlan Dimasi provides clients with real world property research and advice to support all property decisions or strategies.

Advisory: MacroPlan Dimasi offers a suite of commercial and strategic economic and planning advisory services tailored to your needs. Our focus is on supporting value add outcomes for our clients.

Our Services



QUALITATIVE CRITERIA

Skills and Experience of Key Personnel

MacroPlanDimasi

ANDRE MARCELINO

Role: Demographer
B. Economics & Law
Dip. Project Management

André joined MacroPlan after two years as an Economist and seven years as an Analyst in Planning and Development, and Organization & Methods for Toyota Motor Corporation. His experience includes land use consulting, economic and demographic modelling, formulation of strategic planning, structural reorganization and implementation of new management methods.

André advises on optimisation of financial resources and assets. He conducts analysis and research into economic, demographic and market trends to support the best investment opportunities and financial resources.

MacroPlanDimasi

ALEX SAUNDERS

Role: Spatial Analyst
GradDip. GIS
M. EIA
B. Science - Economics

Alex is a highly qualified Senior Geographic Information Systems specialist with more than 12 years' experience in the utilisation of GIS in the field of urban planning and infrastructure coordination. Alex has, for many years, been a leader in the field of GIS and has received industry awards for both the GIS and urban planning components of his work.

MacroPlanDimasi

IRIS MARCOS

Role: Analyst
B. Commerce – Property
API Member

Iris recently joined MacroPlan Dimasi from Darrell Crouch and Associates Pty Ltd and has a hands on approach to Property Management. With solid problem solving, analytical skills and strong business acumen, she has been a significant contributor to the successful and profitable management of over 600 commercial properties in Perth.

QUALITATIVE CRITERIA

Skills and Experience of Key Personnel

A brief description of skills and experience of the project team personnel is given below and a complete curriculum vitae have been provided in ANNEX THREE.

<p>MacroPlanDimasi</p> <p>STUART MCKNIGHT Role: Project Director B. Science - Psychology GradDip. Entrepreneurship MBA</p>	<p>Stuart has 13 years experience in the banking, finance and economic sector and 12 years experience in the planning and property sector. Prior to joining MacroPlan Dimasi Stuart led the Urban Development Program for the WAPC, which addressed land and infrastructure development across WA's growth centres.</p> <p>As Director Portfolio for EPRA Stuart led the urban renewal team managing the entire project life cycle including feasibility assessments, land acquisition, master planning, asset management and place activation.</p>
<p>MacroPlanDimasi</p> <p>JENAYA SHEPHERD Role: Project Manager M. Science - Planning B. Engineering - Civil NLP Practitioner</p>	<p>Jenaya has worked for more than ten years across the Built Environment sector in private and public roles. She has considerable experience in consultancy, urban regeneration, sustainable design and place making. She has managed and been involved with projects in Australia, Malaysia, Timor and Kazakhstan and the United Kingdom.</p> <p>Before joining MacroPlan Dimasi Jenaya headed up strategy and design for the EPRA where she led the Central Perth Community Needs and Infrastructure Plan partnership, prior to taking up post as Principal Urban Design for the MRA.</p>
<p>MacroPlanDimasi</p> <p>GARY WHITE Role: Strategic Advisor B. Regional Town Planning GradDip. Business</p>	<p>Gary has over 35 years experience in planning at a number of levels and is acknowledged as one of Australia's most experienced strategic planning experts. Gary brings an understanding of the grass root issues in planning, and the delivery of strategic plans and frameworks.</p> <p>Gary has undertaken statutory and strategic planning, consultation and visionary work in context of both outcomes and the delivery of change. He has been responsible for the preparation of award winning centres plans, planning schemes and regional plans in addition to review of state planning legislation in QLD and NSW.</p>
<p> ANDREA YOUNG Role: Social Planner Dip. Planning GradDip. Recreation Studies PIA Fellow</p>	<p>Andrea Young is a founding member of the Social Planning Chapter and fellow of PIA. She is a leading national social planner who has practiced extensively in integrating statutory and community development approaches to deliver more effective planned outcomes that address the complex social and cultural needs of communities.</p> <p>Andrea has wide practice experience in social planning and has authored a number of guides on social planning and conducted various training courses in social planning. She was a contributing author to the <i>Implementation Guide No. 5 Social Infrastructure Planning June 2007</i> which has received national awards and become a valued reference for social infrastructure planning.</p>

Jenaya Shepherd | Manager – Planning

Jenaya has worked for more than ten years across the Built Environment sector in private and public roles. She has considerable experience in urban regeneration, sustainable design and place making. Her has presented the opportunity to manage and be involved with projects in Australia, Malaysia, Timor and Kazakhstan and the United Kingdom.

She has also worked on a number of high profile design, policy and master planning projects such as the Strategic Vision for Bournemouth (UK), Sustainable Travel Sutton (UK) and Activities Centre Framework for the Department of Planning (Western Australia).

In her previous role before joining MacroPlan Dimasi, she headed up strategy and design for the East Perth Redevelopment Authority (EPRA).

Professional Experience

- 2010-present Urban Strategy & Design Manager, Metropolitan Redevelopment Authority, Perth, Western Australia
- 2009 Urban Designer, Urban Design Centre of WA, Perth, Western Australia
- 2005-2008 Senior Consultant, Colin Buchanan, London, England
- 2003-2004 Development Control Officer, Surrey County Council, Surrey, England
- 2001-2002 Lead Design Engineer, Structerre Consulting Group, Perth, Western Australia
- 2000 Structural Design Engineer, Connell Mont McDonald, Perth, Western Australia

Professional skills

- Sustainable and Safe Design
- Collaborative Planning
- Community and Stakeholder Engagement
- Regeneration and Renewal
- Policy
- Place Making

Major Projects (past experience)

- Elizabeth Quay Environmentally Sustainable Design Guidelines, Perth
- Community Infrastructure Plan, Perth
- Climate Risk and Adaptation Plan 2012
- Housing Needs Assessment 2011
- Travel Plan Development Policy 2011
- Legislative Options for Passive Geothermal 2011
- EPRA Green Office Plan 2010
- Environmentally Sustainable Design Guidelines: Waterbank Precinct, Perth Australia 2010
- Sustainable Policy Review: Subiaco Redevelopment Authority, Perth Australia 2010
- State Metropolitan Planning Policy: Activity Centre Model Framework, Perth Australia 2009
- Sustainable Policy Review: Smarter Travel Sutton, Greater London UK 2006
- Strategic Planning
- City Visioning: Considering Perth, Perth Australia 2010
- Capital City Planning Framework, Perth Australia 2010
- Movement and Public Space Strategy: Kings Cross, London UK 2008
- Strategic Network Assessment: Central Financial District, Almaty Kazakhstan 2007
- Urban Town Extension: Kettering, Northamptonshire UK 2006



Qualifications

- MSc Spatial Planning (RTPI), Oxford Brookes University, England 2006
- BEng Civil Engineering (Hons) University of Western Australia, Australia 1999
- Neuro-Linguistic Programming (Practitioner), Dynamic Creation, Australia 2011

Affiliations

- Royal Town Planning Institute, UK
- Consultation Institute, UK
- Place Leaders



**MacroPlan
Dimasi**

Understanding today. Anticipating tomorrow

NSW | VIC | QLD | WA

Ground Floor,
12 St. George's Terrace
Perth WA 6000
P: 61 8 9225 7200
F: 61 8 9225 7299
M: 0467 611 801

E: shepherd@macroplan.com.au
W: www.macroplan.com.au

Gary White | Chief Planner Queensland

Gary brings to MacroPlan Dimasi a wealth of planning knowledge. He has had extensive experience in senior roles within Queensland's local and state governments.

Between 1977 and 2001, Gary was the Director of Planning and Community Planning for the Redland Shire Council before being appointed to the position of Centres' Planning Manager with the Gold Coast City Council.

In 2002, Gary commenced as a City Planner for Ipswich City Council at a time when focus for growth in South East Queensland moved towards the Western Corridor.

In July 2008, Gary was appointed to the position of Deputy Director-General, Planning Group, Department of Infrastructure and Planning.

From 2000 to 2004, Gary held the position of President, Queensland Division of the Planning Institute of Australia. He is currently the Queensland representative on the National Council of the Planning Institute of Australia.

In September 2008, Gary became chair of the Planning Officials' Group, which comprises senior planning officials from the Commonwealth, States, Territories and New Zealand planning agencies. The Group provides strategic planning advice to Ministerial councils, and actions relevant items referred by the Council of Australian Governments (COAG).

Whilst working for the Department Gary oversaw the finalisation of the award-winning Far North Queensland Regional Plan; and the South East Queensland Regional Plan 2009-2031 as well as the continued rollout of 3 other regional planning frameworks in the State.

Gary has played a key role in a response to population, town centre and growth issues, across Queensland and has played a key role in Regional plan development in South East Queensland. Gary was appointed to this position of Government Planner in Growth Management Queensland in 2010, this was the first time such a position was created at a State Level in Australia.

During 2011, Gary represented the Queensland Government on the Commission of Inquiry into the Floods of January 2011 and

was called to give advice before the commission on two occasions.

Gary has also been involved in the drafting of planning legislation, playing a role in the review of Sustainable Planning Act 2009, which was introduced in December 2009.

In September 2012, Gary was appointed an expert advisor to the New South Wales Government to assist in the development of a White Paper in association with the review of the States Planning Legislation.

Professional Experience

- PIA President (2002-2004). Lead role in acceptance of the regional plan
- Sitting member of National Council Planning Institute of Australia (2006-2012)
- Sitting member Great Barrier Reef Marine Park Authority
- Immediate Past Chairman (2008-2011) Planning Officials Group – (advised COAG on city planning issues)
- Keynote speaker numerous international, national and state conferences
- Queensland Floods Enquiry - Government Planning Representative (2011)

Major Projects

- Native Title claim by the Quandamooka People
- Cleveland Town Centre Plan and integrated with Harbour Development and Railway Station
- Regional Cities Victoria – city growth model & strategic audit
- Fishermans Bend, Places Victoria
- Gold Coast Competitive Centres Review
- NSW Government White Paper – Expert Advisor
- Award Winning Far North Queensland Regional Plan
- Award Winning South East Queensland Regional Plan (2009-2031)
- Townsville's Futures Plan (2010)
- Ipswich Strategic Vision – Liveable Cities award (London 2008)
- Ipswich CBD Revitalisation Plan
- Ripley Valley Master Plan
- Upgrades to Springfield Master Plan; design work to position new railway station
- Award Winning Redland Town Planning Scheme
- Logan City Council Peer Review



Qualifications

Bachelor in Regional Town Planning (UQ)

Postgraduate Diploma Business Administration (QUT)

Professional Associations

Life Fellow, Planning Institute of Australia
Corporate Member, Property Council of Australia



**MacroPlan
Dimasi**

Understanding today. Anticipating tomorrow

NSW | VIC | QLD | WA

GOLD COAST

Level 1, 1 Le Boulevard, 2 Elkhorn Ave
Surfers Paradise QLD 4217

BRISBANE

Level 15, 111 Eagle Street
Brisbane QLD 4000

P: 61 7 3221 8166

F: 61 7 3221 8177

M: 0407 996 442

E: white@macroplan.com.au

W: www.macroplan.com.au

Carlo Di Giulio | Senior Consultant

Planning & Urban Design

Carlo has 10 years professional experience encompassing statutory planning, strategic planning, urban design and Development Application management.

Carlo commenced his career with positions in several metropolitan Sydney local governments. During this period, he gained a thorough understanding of the development assessment process, in particular Development Applications. In 2007, he entered into private consultancy undertaking a broad variety of strategic and statutory planning projects.

Carlo has also pursued several NSW Land and Environment Court cases, for either private development proponents or on behalf of local councils. He has acted in either an assisting role, or as the Planning Expert appointed by the development proponent.

In 2010, Carlo attained the Master of Urban Development and Design from the University of New South Wales (UNSW). He has since actively pursued urban design related projects. They include acting as lead design advisor for various Development Applications/Planning Proposals or providing design critique to development proponents. Subsequently, Carlo has developed a particular interest for urban regeneration projects.

Carlo is an active member of the Property Council of Australia, the Urban Development Institute of Australia as well as various local representative groups such as the Bondi Junction precinct committee and the Liverpool City Chamber of Commerce.

Carlo has a keen interest in sustainable development as well as contributing to economic development. He sees sustainable urban redevelopment as a means of achieving economic progress.

Summary of Professional Skills

- Prepare, lodge and manage a range of applications, including Development Applications, 'Part 3A' Major Project Applications, State Significant Development Applications, Planning Proposals and 'Section 82A Reviews'.
- Prepare Statements of Environmental Effects.
- Prepare View Impact Assessments.
- Undertake Residential Flat Building assessments pursuant to 'SEPP 65'.
- Undertake signage analysis according to 'SEPP 64'.
- Act as 'Planning Expert' in NSW Land and Environment Court proceedings, including preparation of 'Statements of Basic Facts and Contentions', undertake 'Joint Expert' meetings or attendance at 'Section 34' on site conferences.
- Preparation of 'Voluntary Planning Agreements'.
- Strategic land use planning.
- Due diligence advice.

Recent Projects

- Assistance with preparation of the Wagga Wagga, Helensburgh and Bombo Quarry LEPs.
- Various Development Applications for development proponents including a twenty-two (22) unit Residential Flat Building in the Liverpool CBD and a seven (7) unit Residential Flat Building in Kingsford.
- Assistance with NSW Land and Environment Court Class 1 Appeals for a Residential Flat Building on Alison Road, Randwick, the extension of the Clovelly Hotel, including acting as 'Planning Expert' for a successful appeal relating to a single dwelling on Blaxland Street, Hunters Hill.
- Successful high density residential Planning Proposal at West and Brighton Streets, Petersham.



Qualifications

- Bachelor of Town Planning, University of New South Wales (2005)
- Master of Urban Development and Design, University of New South Wales (2010).



**MacroPlan
Dimasi**

Understanding today. Anticipating tomorrow
NSW | VIC | QLD | WA

Level 4
39 Martin Place
Sydney NSW 2000
P: 61 2 9221 5211
F: 61 2 9221 1284

E: digiulio@macroplan.com.au
W: www.macroplan.com.au

Sally Prowd | Consultant

Planning

Since joining the Sydney MacroPlan Dimasi team, in June of 2013, Sally has brought experience in planning, research, and reporting. Sally is a qualified town planner with a background in private sector planning consultancy.

Sally brings expertise in various aspects of research as well as writing and submitting development applications. Her knowledge extends across both the Queensland and New South Wales planning systems.

Prior to working at MacroPlan, Sally had experience aiding in the assessment of development applications on behalf of Regional Councils' in Queensland. She also has an understanding of surveying and as such she can read and interpret plans and other drawings with ease.

Sally has worked in the realm of both rural and metropolitan planning. She has continued to diversify her professional skill set throughout her time with MacroPlan Dimasi.

Since graduating with first class honours Sally has continued to work within the realm of both local and state government legislation and regulations. Her degree has provided her with experience and understanding of the environmental, social, cultural and economic aspects of planning from site specific through to regional scales.

Recent Projects

- Various Development Applications to City of Sydney Council for Change of Use in Alexandria.
- Preliminary Development Application for a Shop in Ashfield.
- Modifications to State Significant Development in the Wahroonga Estate.
- Modification to Wollongong Hospital Major Project.
- Application to Round Five of the National Affordability Rental Scheme in Wyong and Camden.
- Development Applications for a Material Change of Use in Virginia.
- Yield Assessment for a project in Riverstone.
- Modification to Service Station Developments in Nabic and Cranebrook.
- Pre-Gateway Review Application for a proposal in Casula.



Qualifications

- Bachelor of Town and Regional Planning (Hons I), University of Queensland (2012).



MacroPlan
Dimasi

Understanding today. Anticipating tomorrow.

VIC | NSW | QLD | WA

Level 4,
39 Martin Place
Sydney NSW 2000

P: 61 2 9221 5211
F: 61 2 9221 1284

E: prowd@macroplan.com.au
W: www.macroplan.com.au

Alex Saunders | Senior Manager - GIS

Alex is a highly qualified Senior Geographic Information Systems specialist with more than 12 years' experience in the utilisation of GIS in the field of urban planning and infrastructure coordination. Alex's innovative approach to GIS has led to industry awards for both the GIS and urban planning components of his work.

Professional Experience

- 2013 MacroPlan Dimasi, Senior Manager – Spatial Research
- 2012 - 2013 Aurecon Australia, Perth, Australia Senior GIS Analyst
- 2012 – 2013 Spatial Economics Pty Ltd, Perth, Australia - Director
- 2000 to 2011 Department of Planning, Perth, Australia - Geospatial Analysis
 - 2007 – 2011 Planning Manager - Geospatial Analysis
 - 2003 – 2007 Senior Project Officer Geospatial Analysis
 - 2000 – 2003 GIS Specialist
- 1996 – 1999 Encams Ltd, Environmental Advisor
- 1992 – 1995, British Gas plc, Senior Marketing Planning Officer

MAX Light Rail – Urban Economics and Property Assessment

GIS based assessment of the potential impact of the proposed MAX Light Rail Transit corridor on population, housing and employment within proximity of the proposed alignment over a 30-year time frame. Study involves detailed assessment of existing and future housing, employment and demographics.

Major Projects (past experience)

- Regional Growth Monitor – creation of a growth capacity and monitoring model for Western Australia's regional urban centres.
- Urban Growth Monitor (UGM) - creation of a long-term land supply model for Perth, Peel and Greater Bunbury. The UGM received planning awards from the Planning Institute of Australia and GIS awards from the Surveying and Spatial Sciences Institute.
- Urban Development Program Online (DevNet) - conceptual model design, data model functionality, query capability and product specification.
- Integrated Land Information Database - design and development of a statewide property geodatabase providing a lot-by-lot evaluation of development density and subdivision potential based on current statutory planning regulations including the Residential Design codes.
- Hazardous/Industrial Waste Site Selection Study - a major interdepartmental GIS study to identify potential locations for a number of hazardous waste sites within Western Australia through the consultative process



Qualifications

- Graduate Diploma in Science – Geographic Information Systems – University of Western Australia - 2000
- Masters Degree in Environmental Impact Assessment – University of Brighton - 1995
- Honours Degree - Economics (BSc Econ) – University College London - 1989



MacroPlan
Dimasi

Understanding today. Anticipating tomorrow

NSW | VIC | QLD | WA

Ground Floor,
12 St. George's Terrace
Perth WA 6000
P: 61 8 9225 7200
F: 61 8 9225 7299
M: 0402 956 744

E: saunders@macroplan.com.au

W: www.macroplan.com.au

André Marcelino | Consultant - Economics

André is a Consultant (Economics) within MacroPlan's Perth office. André joined MacroPlan after two years as an Economist and seven years as an Analyst in Planning and Development, and Organization & Methods for Toyota Motor Corporation - Mercosul (Brazil/Argentina).

As Economist, André was responsible for the studies and proposals to the optimization of financial resources and assets and development of studies, researches and economic analyses on market trends to support the best investment opportunities and financial resources.

André's experience includes, industrial and commercial consulting and economic modelling as well as data modelling, formulation of strategic planning and the development of plans, structural reorganization and implementation of new management methods.

As a Consultant (Economics), André provides support to the consulting and production team by researching, collating and analysing information.

Professional Experience

- Conduct Financial Investigations, undertake audits, prepare reports and advise
- Formulation of budgetary and accounting policies
- Skilled market demand and supply studies
- Economic modelling as well as data modelling and data analysis for a number of consulting projects.
- Strategic analysis and design advice.
- Market research
- Implementation ISO 14001

Major Projects

Since joining MacroPlan in Jan 2013, André has undertaken a number of projects:

- Southern Cross Care Portfolio Strategy
- Ridgewood Development Strategy
- Local Planning Strategy for the Shire of Roebourne
- Industrial Land Development Benchmarking Study
- Review of Jandakot Airport Master Plan 2009
- Banksia Grove NRAS
- Student accommodation NRAS
- Kimberley Land Council Ecosystem-based Economic Development: Scoping and Concept Plan
- King's Square Market Assessment
- Redevelopment of the Les Hansman Community Centre
- Light Rail Development
- Perth Commercial Market Outlook Report
- Preston Beach: Value of Construction and Infrastructure
- Perth Residential Market Outlook Report
- Hazelmere Light Industrial and Commercial Market Assessment
- Rockingham Market Assessment



Qualifications

- Bachelor of Economics University Fundação Santo André (2006)
- Bachelor of Law University of Law São Bernardo (2007)
- Diploma of Project Management



MacroPlan
Dimasi

Understanding today. Anticipating tomorrow

NSW | VIC | QLD | WA

Ground Floor,
12 St. George's Terrace
Perth WA 6000
P: 61 8 9225 7200
F: 61 8 9225 7299
M: 0430 654 427

E: marcelino@macroplan.com.au
W: www.macroplan.com.au

Iris Marcos | Analyst - Property

Iris is an Analyst within MacroPlan Dimasi's Perth office. Iris recently joined MacroPlan after working as an Assistant Commercial Manager for Darrell Crouch and Associates. She has recently completed a Bachelor of Commerce majoring in Finance and Property from Curtin University, Western Australia.

As an assistant commercial manager Iris has gained experience in Commercial Property Management and was a significant contributor to the successful and profitable management of over 600 commercial properties in Perth, Western Australia.

Iris' background in the commercial property industry brings local commercial property experience to the Perth MacroPlan Dimasi team.

Professional Experience

- Day-to-day commercial management;
- Facilitating building maintenance schedules;
- Budget forecasting;
- Market appraisal and rent reviews;
- Market research;
- Lease and rent negotiations; and
- Day-to-day bookkeeping.

Major Projects

Since joining MacroPlan Dimasi in December 2013, Iris has been involved in a number of projects which include:

- Lend Lease Apartment Outlook
- RACWA Site Feasibility
- Southern Cross Care Development Strategy
- Port Hedland Marina Analysis



Qualifications

Bachelor of Commerce
(Finance and Property)
Curtin University

Affiliations

Australian Property
Institute
Property Council
Australia



**MacroPlan
Dimasi**

Understanding today. Anticipating tomorrow

NSW | VIC | QLD | WA

Ground Floor,
12 St. George's Terrace
Perth WA 6000
P: 61 8 9225 7200
F: 61 8 9225 7299
M: 0432 594 549

E: marcos@macroplan.com.au
W: www.macroplan.com.au

QUALITATIVE CRITERIA

Relevant Experience

Relevant project experience completed by the project team is illustrated below and a selection of MacroPlan Dimasi specific experience is given in the following pages. Relevant project experience from the other team members has been provided in ANNEX TWO.



Referees

Project	Client	Completed	Contact	No.
Les Hansman Community Centre Redevelopment	City of Bayswater (WA)	2013	Lou Cotter Director, The Buchan Group	(08) 9211 9898
Boroondara Youth Facilities Needs Assessment	City of Boroondara (VIC)	2010	Tara Jarvis Coordinator Youth Services, City of Boroondara	(03) 9278 4444

QUALITATIVE CRITERIA

Relevant Experience

Central Perth Community Infrastructure Plan 2012 **MRA and City of Perth WA**

Jenaya Shepherd managed the study partnership between the City of Perth and the Metropolitan Redevelopment Authority to deliver a Community Infrastructure Plan for the central Perth area, including the CBD and surrounding mixed use residential areas.

The Plan's objective was to identify future social infrastructure requirements over a 20 year period. Jenaya structured the Plan to be a useful tool for decision making by ensuring the what, where, when and how of the identified needs were clearly articulated.

Tasks completed as part of the study included:

- Identify suitable delivery models to meet the future needs within the partnership governance framework.
- Define location, size, catchment and nature of the community facilities required.
- Recommend and map strategic sites to meet any immediate deficit and future demand.
- Prepare an order of magnitude cost schedule and define an implementation and phasing strategy.

The Plan was adopted by the MRA board in 2012 and now informs the establishment of developer contributions in central Perth Redevelopment Areas.

Central Perth Community Needs Assessment 2011 **MRA and City of Perth WA**

Jenaya Shepherd coordinated the study partnership between the City of Perth and the Metropolitan Redevelopment Authority to deliver a Community Needs Assessment for the central Perth area. The purpose of the assessment was to provide the evidence base for the future provision and prioritisation of community facilities and services.

Jenaya led a population forecasting and demographic assessment to underpin the study. She also coordinated the consultation which involved engaging city workers, residents and visitors through on-ground surveys, meetings and workshops with service providers and stakeholders, and interviews with key officers from the partner organisations.

Tasks completed as part of the study included:

- Defining the role and current hierarchy of community infrastructure.
- Developing a process for auditing the operation of existing facilities within the city.
- Identification of the four types of need – normative, felt, expressed and comparative within the local context.
- Benchmarking desired standards of service.
- Defining standards of provision relative to local context.

The needs assessment informed the preparation of a community infrastructure plan.

QUALITATIVE CRITERIA

Relevant Experience

Redevelopment of the Les Hansman Community Centre 2013 **City of Bayswater WA**

MacroPlan Dimasi was engaged by the City of Bayswater as part of a consulting team led by the Buchan Group to prepare a market assessment report and a financial feasibility analysis.

The market assessment report contains an overview of the State economy, local demand drivers and the current offering of community facilities in Morley to determine the potential uses that could be accommodated at a redeveloped Les Hansman Community Centre

A market assessment report identified that given the market demand, competition and location of Les Hansman Community Centre that there is a re-development opportunity for:

- Community facilities
- Commercial office space
- Consulting/medical suites
- Leisure and entertainment uses
- Apartment and serviced apartments

Boroondara Youth Facilities Needs Assessment 2010 **City of Boroondara VIC**

MacroPlan was engaged by the City of Boroondara to develop a business case for a new Youth Services facility. The goal of the business case was to demonstrate a prima facie case justifying the relocation of Boroondara Youth Services to a new site/facility within the municipality.

To develop the business case, MacroPlan undertook:

- A needs assessment
- A potential site selection assessment
- A benefits assessment.

MacroPlan's report assisted Council in meeting their obligations under the Boroondara Youth Strategy.



QUALITATIVE CRITERIA

Relevant Experience

Cairns Southern Growth Corridor Community Infrastructure Review 2008 Denor Group (QLD)

MacroPlan was commissioned by a major land owner in the Cairns Southern Growth Corridor to undertake a review of community infrastructure in the Corridor.

This was needed to determine future requirements to cater for the proposed land release of Mount Peter, and to determine the likely timing of that supply to meet community need in the area.

The tasks completed:

- High level review of community infrastructure
- Demographic analysis and forecasting
- Development of community facilities gap analysis and recommendations

MacroPlan identified that there was a need for a number of additional community facilities within the growth corridor, both now and into the future.

Riverstone Demographic and Community Infrastructure Report 2007 Growth Centres Commission (NSW)

MacroPlan was commissioned to undertake a study to assess the future demographic profile of the Riverstone and Alex Avenue Precincts in Sydney's North West Growth Centre.

MacroPlan was required to develop a plan for appropriate levels of community facilities, social infrastructure and open space/recreational facilities .

MacroPlan undertook:

Demographic analysis and forecasting;
Developed market take-up facilities and services recommendations
Identified open space and recreation needs.

The study has assisted the GCC with the staged delivery of infrastructure coordinated with staged land release; and the management and delivery through new governance arrangements, release sequencing, streamlined planning and funding administration.



QUALITATIVE CRITERIA

Relevant Experience

NSW Public Libraries Cost benefit Analysis 2009

State Library of New South Wales (NSW)

MacroPlan was commissioned by the State Library of NSW to explore, establish, analyse and document the costs and benefits of outsourcing public library services in a variety of contexts relevant to the NSW public library network.

An informed comparison between outsourcing, in house provision and a combination of these collection management models was also developed as part of the project.

MacroPlan's report established a benefit cost framework that identified the quantitative and qualitative benefits and costs of outsourcing.

West Riverstone Precinct Community Facilities Study 2008

North West Transport Hub (NSW)

MacroPlan was commissioned to undertake a community facilities study to investigate the future needs of the Riverstone West Precinct.

In completing the project, MacroPlan undertook:

- A situation analysis
- Developed social infrastructure guidelines
- A demographic analysis
- Reviewed existing community infrastructure and identified provision gaps
- Identified future opportunities

MacroPlan also advised on delivery models including community hubs, co-location of services and regional community infrastructure opportunities.

MacroPlan's report provided broad principles and suggestions which assisted in determining the most appropriate type of community facilities to be introduced at Riverstone West Precinct.



Request for Tender: 14/07

Architectural/ Landscape Consultant Services for
Port Hedland Community Planning
(Open Space and Infrastructure) Master Planning



Sports /Stadia &
Aquatic

Community

Retail

Cinematic

Residential &
Aged care

Defence &
Industrial

Our Approach

Our Approach

We are a practical yet designed focused architectural practice, with the ability for cutting edge design and buildability.

At Etch, we respect our Clients' aspirations, ideas, time and financial constraints.

We build a relationship based on trust and excellent service with a very close personal relationship.

Our Architectural, Project Management and Landscape design services embraces the provision of a more holistic approach, one that respects and integrates both built and landscape elements as one, along with our project management expertise which we place emphasis on quality, time management controls and procedures which in turn guarantees a successful completion of our projects.

Communication

The importance of effective communication is critical in any design process.

Etch listens.

We place a strong emphasis on taking the necessary time to define, consider and understand our Client's brief, including identifying potential risks in order to deliver the best possible outcomes.

Etch respects and values Clients' contributions and encourages ongoing involvement in all stages of the project.

We strive to build strong and lasting relationships through personalised service, and by working closely with the Client, users and stakeholders.

The stronger the team relationship, the stronger and more successful the outcome.



Services

Masterplanning

Integration of Community Hubs with Retail Sports & Residential Facilities, Spatial Concepts Review and Design

- Landscape and spatial interaction
- Project Peer Review
- Functional consideration
- Evaluate brief vs. budget
- Adaptive re-use
- Town planning
- Development applications
- Retail Planning
- Sports Precinct Planning
- Cinematic Design

Specialist Design

- Facility & Essential services planning

Sports & Leisure

- Stadia Design + Grandstand
- Drycourt + Hardcourt design
- Project Peer Review
- Passive energy systems
- Technical consultation/review
- Aquatic Design
- Technical Knowledge of Sport Industry Facility Standards
- Sports fields

Retail

- Shopping Centres & Malls
- Outdoor Mall Strip Retail Outlets
- Tenancy fit-out coordination
- Planning of major/minor & speciality retail outlets

Defence Services

- Security planning & infrastructure
- Facility Design
- Project Peer Review
- Re-vegetation/Ecological Designs
- Defence facility planning
- User facilitation

Feasibility Studies

- Recreation studies
- Spatial planning & site planning
- Aquatic facility investigations & review
- Environmental review
- Functional Design Briefs
- Strategic Business Cases

Project Planning & Management

Community consultation and involvement

- User groups
- Stakeholder management
- Existing condition review
- Independent project reviews
- Plant selection review/planting schemes
- Design time-line management
- Co-ordinate specialist consultants
- Cost estimate reviews with Quantity Surveyors

Building / Landscape Audits

- Site / building investigations
- Condition observation audit
- Property consultation (landscape)
- Review of expansion considerations/rationale
- Asset management & facility audits

Construction

- Full contract documentation
- Tender evaluations
- Tender & contract negotiation
- Contract administration
- Site meetings
- User groups
- Involvement and evaluation reviews
- Client/stakeholder meetings to maintain an ongoing process during construction
- Post-occupancy reviews & observations

Landscape & Re-vegetation

- Indigenous planting schemes
- Water sensitive design & planting schemes
- Plant selection
- Sustainability

Etch is fully committed to deliver a quality service that provides value, innovation and satisfaction. We treat each project on an individual basis providing solutions tailored to the project, Client and users.

etchsport

Projects and Experience

Including Facility Management Plans and Building Audits, Architecture, Project Management, Landscape, Master planning, Feasibility Studies and Urban Design.

- Sale Recreation Review - Cobain Road (A+L)
- Melbourne Cricket Ground A + PM
- Rosedale Outdoor Pool (A + L)
- Rosedale Recreation Reserve (A)
- Croydon Junior Football Club (A)
- Aquatic and recreation Victoria - Function Design Template (A)
- Alexandra Community and Leisure Centre (A)
- Wellington Shire Aquatic Study (A)
- Southern Grampians - Aquatics Study (A)
- Gippsland Recreation reserves (A)
- Nyora Sports Pavilion (A)
- Swim Education Australia - Pools for schools program (A +L)
- Yarra Ranges, Regional Aquatic Centre (A+L)
- Glenroy Bowls Club (A +L)
- Monbulk Sports Pavilion (A)
- Dandenong Soccer Hub - feasibility Study (A)
- Netball Precinct and Regional Aquatic Centre (A)
- Gippsland Regional Sports Centre (A +L)
- Sale Mall Redevelopment - design competition (A +L)
- Dandenong Soccer Hub - Feasibility Study(A)
- Banyule - State Indoor Hockey - Feasibility Study (A)
- East Gippsland Recreation Master plan
- Wellington Indoor Sports and Community Centre (NZ) (A) - ASB Centre
- Maffra outdoor 'memorial' pool (A + L)
- Sale, 'Aquaenergy' Regional Aquatic Centre(A)
- Sandringham Football and Social Club redevelopment (A)
- Stratford Outdoor Pool - Change rooms (A)
- Sydney Olympic Pool - new water play (NSW) (A)
- Gippsland Regional Sports Complex (A + L)
- Aqua - energy - Stage 2 - gym extension (A)
- Glen Eira Aquatic Centre (water slides only) (A)
- Heyfield Outdoor 'memorial' Pool redevelopment (A)
- Ararat Outdoor Olympic Pool redevelopment (A +L)
- Yarram Outdoor Pool redevelopment (A)
- Kingston Leisure Centre - cafe and pool seating redevelopment (A + L)
- Pinks Reserve Regional Netball Facility (A +L)
- Ruth Everuss Aquatic Centre (NSW) (A +L)
- Traralgon Indoor Aquatic Centre (A +L)
- Hamilton Outdoor Olympic Pool - pool plant and pool heating upgrade (A)
- Kununurra Aquatic & Leisure Centre (W.A) (A + L)

Through Greg Chatelier Senior Project Leader and Sean Stone (Director) Etch's experience in Retail, Sports recreation & Community Facilities range from The MCG through to local Club and community Facilities.



The Melbourne Cricket Ground (Greg Chatelier)



Boroodara Sports centre



Gippsland Regional Sports Complex - Main Stadium

etchsport

Projects and Experience

Including Facility Management Plans and Building Audits, Architecture, Project Management, Landscape, Master planning, Feasibility Studies and Urban Design.

- Hawthorn Bowls Club
- Glenferrie Hill Recreation Club
- Australian Gallery of Sport
- Wodonga Olympic Pool
- North Melbourne Football Club Redev concepts
- Surrey Park Baseball Club
- Nunawading Aquatic Centre
- AFL Sportsready Offices
- Junction Oval First Class Cricket set up
- Punt Road Oval Redevelopment
- MPV - Rod Laver Arena concept study
- Panthers Rugby League Club Redevelopment
- Sports City Bangkok
- MCC Squash Club
- Transportable Wickets Darwin & MCG
- Albert Ground Redevelopment
- Olympic Soccer MCG
- Various Concerts and staging MCG
- Involvement in Northern stand and southern stand redevelopments MCG through Greg Chatelier
- London 2012 Aquatic Submission Design competition
- Gordon Barnard reserve
- Cardinia Sports and Aquatic Centre
- Cabramatta Sports and Aquatic
- Ararat Indoor Pool Redevelopment
- Central Park Reserve
- Gisborn Aquatic Centre
- Sydney Olympic Pool Fitout and change upgrade
- Riversdale Golf Club
- Various MCG Projects Include. - Refer to Relevant experience project highlights with reference to Melbourne Cricket Club.

Other projects include:

- Penrith YMCA Stadium (NSW)
- Geelong Arena Redevelopment
- for Melbourne 2006 Commonwealth Games
- Borella (Sports) Club, Bandiana
- Mount Lilydale College Multi-Purpose Facility
- Croydon Indoor Recreation Centre
- Greensborough Principal Activity Centre
- LaTrobe University new Sports Centre
- Alfred Deakin Centre, Mildura
- Melbourne Sports & Aquatic Centre
- Raymond Terrace Aquatic Centre (NSW)
- Kurri Kurri Aquatic Centre (NSW)
- Doncaster Aquatic Centre (Family Change)
- Broadmeadows Aquatic Centre
- Blacktown Aquatic Centre (NSW)
- Coburg Aquatic Centre
- Dubbo Leisure Pool (NSW)
- Emerton Aquatic Centre (NSW)
- Lane Cove Aquatic Centre (NSW)



Sale Aquatic Centre



Geelong Arena Redevelopment (Melbourne 2006)



Albert Ground for Cricket Victoria & MCC



Hawthorn Bowls Club



Junction Oval - First Class Cricket Cricket Victoria

etchsport - Project Highlights



Wellington Indoor Community Sports Centre (ASB Centre)

ARCHITECTURE

Client: Wellington City Council. New Zealand
 Cost: \$44 million NZ
 Period: Nov 2006 – August 2011.
 Architect: SKM Wellington &
 Tennent Brown Architects
 Contact: Mr Jamie Delich

Etch was commissioned by SKM Wellington & Tennent Brown Architects to provide specialist recreation 'spatial' planning, and project 'design' of the new 12 indoor netball court stadium.

Etch also provided technical Peer Review and facilitated all user group and stakeholder workshops.

The project comprises:

- 12 indoor 'international standard' netball / basketball courts
- 8 international standard volleyball courts
- 2500 portable seating for a show court
- 300 seat cafe / function room
- administration
- public & competition change facilities
- retail and commercial areas
- undercover parking
- Basketball Wellington administration headquarters
- proposed training venue for 'Silver Ferns' New Zealand netball team



ASB Centre the WINNER of 'Public Architecture' Category for the NZ Architectural Design Awards 2012

etchsport - Project Highlights



Preliminary 3D image concept design

ARCHITECTURE AND LANDSCAPE

Client: **Tweed Heads Shire**
 Estimated Cost: **\$25million**
 Period: **May 2013 - current**
 Contact: **Stewart B**

Etch, in conjunction with @Leisure Recreation Planners, is commissioned to prepare a Feasibility Study and Concept Design (for DA Application) for Stage 2 works at Arkininstall Park which includes a multipurpose stadium and regional soccer facility.

This facility is to link the existing Arkininstall Netball and Tennis precinct and to create a civic hub for the region.

Stage 2 comprises:

- 4 court basketball and netball stadium
- gymnastics hall
- cardio gymnasium
- associated facilities
- commercial kitchen/cafe
- community sports administration area
- change facilities
- 1 x A grade 'natural turf' soccer pitch
- 2 x B grade 'natural turf' soccer pitch
- 1 x artificial turf training pitch
- pavilions
- general passive pathways and landscaping



existing soccer pavilion



3D image concept design - preliminary

etchsport - Project Highlights



Monbulk Recreation Reserve

Client: Yarra Ranges Council
 Estimated Cost: \$2.0 million AUD approx
 Period: November 2012 - current
 Contact: Ben Bainbridge
 (Manager Recreation Services)

Etch was commissioned to design a Sports Pavilion Facility dedicated for the use of the Monbulk Cricket and Football Clubs and shared facility with the Netball users.

The aim was to provide a under one roof facility to house social room and associated catering, which currently is housed at the log cabin on the existing site and to incorporate the toilets and change facilities within this proposal which currently is housed in an old pavilion separate from the log cabin. Etch lead all User Group facilitation. Project is intended for commencement end 2013

The project comprises of:

- 200 capacity Social Room with new amenities and service kitchen bar and kiosk
- administration team meeting and multipurpose room
- canteen with commercial kitchen
- Gymnasium
- Mixed user internal change facilities to include ambulant facilities
- car parking
- associated landscaping
- Netball change facilities
- Store room
- Medical room & Time keepers area.

The following display 3d model depicts the proposal which demonstrates natural light maximisation with a light timber frame structure and feature roof that creates a floating structure east facing to allow natural floor lighting to all areas of the pavilion.

The pavilion has been designed to allow for an outdoor deck and BBQ family area for weekend events and family days.

The project was designed to be staged with possible monetary constraints allowing the main amenities of the facility to be built first with allowance of the second stage construction consisting of the social area and upper floor.

It was in turn designed to use the existing grade and fall of the land to minimise excavation and use the existing site to house all the required areas.



etchsport - Project Highlights



Gippsland Regional Sports Complex, Sale (Stage 1 & 2)

Client: Wellington Shire Council
 Cost: \$8.5 million AUD
 Period: October 2008 - March 2010
 Contact: Mr Chris Hastie
 General Manager Built Projects

As part of the future Gippsland Regional Sports Complex, Etch was commissioned by Wellington Shire Council (as part of their Federal Government Stimulus package) to design a new indoor/outdoor netball, basketball regional sports centre.

The project comprises:

- 4 indoor 'international standard' netball and basketball courts
- 12 outdoor court netball facility with associated timekeepers area and player shelters
- dedicated administration zone and regional sports facility offices (for both netball and basketball)
- dedicated cafe with commercial kitchen
- change room facilities to accommodate both indoor and outdoor activities
- stormwater retaining lake and landscape wetland swales
- associated car parking and landscaping

This project was delivered as a Design & Construct project with Etch novated to the builder to complete the overall design and to assist in delivery of this project.



Outdoor Netball courts with spectator shelters



Dedicated cafe area



Indoor stadium

Gippsland Regional Sports Complex was awarded the 2012 Institute of Public Works Engineering Australia - Victoria Division - Awards for excellence

etchsport - Project Highlights



Yarra Ranges Regional Aquatic Centre Masterplan

ARCHITECTURE AND LANDSCAPE

Client: Yarra Ranges Council
 Estimated Cost: \$25 million AUD
 Period: June - August 2010
 Contact: Ben Bainbridge
 Executive Officer,
 Recreation Services

- Etch was commissioned to:
- prepare concept designs
 - revisit the previous masterplan
 - re-plan a new facility.

- This new facility is to include:
- 10 lane 25 m pool with accessible ramp
 - 160 sq.m warm water pool with incorporated spa
 - 600 sq.m leisure pool with program space
 - 500 sq.m gymnasium
 - 2 X 200 sq.m multi-purpose rooms
 - cafe
 - general administration
 - associated change facilities
 - creche
 - health and wellness area
 - 200 car park spaces
 - associated landscaping





Yarra Ranges Aquatic Centre Masterplan - Proposed Floor Plan Shire of Yarra Ranges

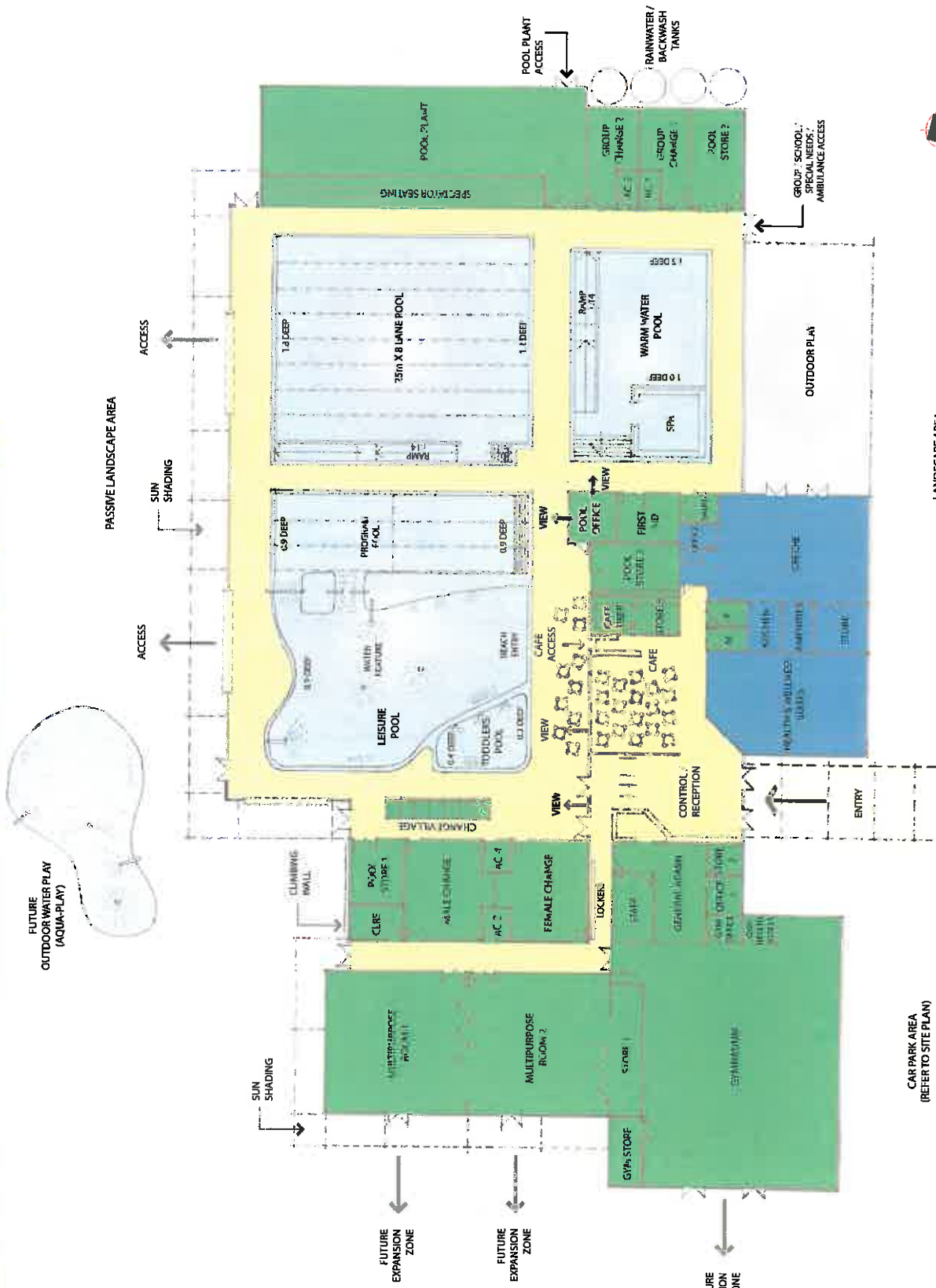

Area Schedule	Area Schedule	Area Schedule
Multi-Purpose Room 1	200 m ²	Multi-Purpose Room 2
Cleaners	20 m ²	Gym Store
Gym Store	23 m ²	Gym Health Assessment
Store 1	45 m ²	Gymnasium Office
Gym Health Assessment	10 m ²	Gymnasium
Gymnasium Office	11 m ²	Staff
Gymnasium	506 m ²	General Admin
Staff	28 m ²	Store 1
General Admin	64 m ²	Store 2
Store 1	14 m ²	Control / Reception
Store 2	12 m ²	Cafe
Control / Reception	132 m ²	Cafe Prep
Cafe	103 m ²	Store 3
Cafe Prep	15 m ²	Pool Store 2
Store 3	17 m ²	Pool Office
Pool Store 2	45 m ²	First Aid Room
Pool Office	23 m ²	Health & Wellness Suites
First Aid Room	32 m ²	Cafe Male
Health & Wellness Suites	156 m ²	Cafe Female
Cafe Male	10 m ²	Creche Office
Cafe Female	10 m ²	Creche Kitchen
Creche Office	172 m ²	Creche Amenities
Creche Kitchen	9 m ²	Outdoor Play
Creche Amenities	16 m ²	25m 10 Lane Pool
Outdoor Play	26 m ²	Spectator Seating
25m 10 Lane Pool	309 m ²	Pool Plant
Spectator Seating	88 m ²	Pool Store 3
Pool Plant	303 m ²	Sauna
Pool Store 3	54 m ²	Group Change 1
Sauna	11 m ²	Group Change 2
Group Change 1	42 m ²	Accessible / Family Change 1
Group Change 2	42 m ²	Accessible / Family Change 2
Accessible / Family Change 1	9 m ²	Warm Water Pool
Accessible / Family Change 2	9 m ²	Spa
Warm Water Pool	230 m ²	Leisure / Program Pool
Spa	59 m ²	Toddler's Pool
Leisure / Program Pool	648 m ²	Change Villages
Toddler's Pool	48 m ²	Female Change
Change Villages	21 m ²	Male Change
Female Change	81 m ²	Accessible / Family Change 3
Male Change	81 m ²	Accessible / Family Change 4
Accessible / Family Change 3	9 m ²	Pool Store 1
Accessible / Family Change 4	9 m ²	Circulation
Pool Store 1	35 m ²	
Circulation	1168 m ²	
Total Area	5751 m²	

BUILDING
LANDSCAPE

etch Architectural Solutions Pty Ltd
Suite 2, Level 1
No. 1 Street, Ringwood
VIC 3134
P: 461 (03) 8773 8134
F: 461 (03) 8773 8056
E: info@etch.com.au
W: www.etch.com.au
A/L: 12/01/2010
T/L: 12/01/2010

Job Number: 01-0793
Day No: 50-06 (A)
Scale: 1:15
Date: August 2010
A/L: 12/01/2010
T/L: 12/01/2010



LANDSCAPE AREA

CAR PARK AREA
(REFER TO SITE PLAN)



Yarra Ranges Aquatic Centre Masterplan - Site Plan

Shire of Yarra Ranges



PEDESTRIAN LINKAGE
Enhance pedestrian linkage to township

MULTI-PURPOSE TRAILS
- 2.4m wide permeable surfaced trails to provide for access throughout the aquatic centre site and to the surrounding area providing localised amenity and observation of the site
- Trails provide opportunities for passive recreational activities including:
- jogging
- walking
- wheelchair
- dog walking
- trails provide for site maintenance and emergency access

LANDSCAPE BUFFER
Landscape Buffer 5: Electrical 'Main' Equipment

SWINBURNE DAY CARE CENTRE
To be relocated into Aquatic Centre

FUTURE PEDESTRIAN ACCESS
- Main pedestrian access corridor to main entry of Aquatic Centre
- Provide pedestrian crossing at Jarilo Drive for future overflow carpark

OVERFLOW CAR PARK
Overflow car park for Aquatic Centre (150 car spaces). Car park surface to be permeable

MAIN CAR PARK
Main car park in close proximity to proposed Aquatic Centre (150 car spaces)

JARILLO DRIVE
Jarilo Drive to remain as a single line road way not a dual carriage way as proposed by Vic Roads

LANDSCAPE BUFFER
- Landscape buffer to be provided to perimeter of all site boundaries (from vegetation buffer to assist in providing screening for light, noise and privacy)
- Wildlife plantings to include indigenous species

PASSIVE ACTIVITY PATHS
Passive activity paths allow for walking and biking

BBO AREAS/SHELTER
- BBO areas located around pool break out area
- Each shelter provides:
- electric BBQ
- 6-8 seater picnic table
(suitable for disability access)

PERIMETER FENCING
Perimeter fencing to control access into Aquatic Centre and minimise vandalism

SUN SHELTERS
Sun shelters around outdoor leisure pool areas

BREAK OUT AREA
Break out area for cut area from pool hall (leisure area)

LANDSCAPE BUFFER
- Landscape buffer to be provided to perimeter of all site boundaries
- vegetation buffer to assist in providing screening for light, noise and privacy
- Wildlife plantings to include indigenous species
- Larger width buffer planting to provide a vegetation area capable of greater diversity and improved biodiversity

STORM WATER RETENTION
- Retention lake and associated infrastructure for the collection of excess site storm water, natural treatment, storage, reuse via site irrigation, and uncontrolled release of excess storm water into the storm system in heavy rainfall events.
- Excess water is captured temporarily for reuse via site irrigation opportunities
- Provision of naturalized habitat

SWALE SYSTEM
- Swale system to be provided to collect excess site storm water prior to discharge into infrastructure
- Swale system to include:
- vegetative zones for base of swale
- native vegetation to assist in removal of excess nutrients from storm water and control water flow rates

BUILDING & LANDSCAPE

FUTURE EXPANSION ZONE

Ephemeral Zone

Creek Zone

Job Number: 14-078
200 %
Scale: 1:500 @ A1
Date: August 2010
E:\Projects\14-078\14-078.dwg

etch Architectural Solutions Pty Ltd
Suite 2, Level 1
Rings Road / Ormond 3134
P+61 (03) 9876 8066
F+61 (03) 9872 8065
a info@etch.com.au
w www.etcharch.com.au
REG 120 712 781



etchsport - Project Highlights



Sandringham Football Club - Social Club Redevelopment

Client: Sandringham Football Club & Bayside City Council.
 Estimated Cost: \$1 million AUD
 Period: February 2009 — May 2010
 Architect: Etch Architectural Solutions
 Contact: Mr Peter Frankyn

Etch was commissioned by Bayside City Council to provide a cost-effective design solution for Sandringham Football Club, for the redevelopment of the Social Club and associated facilities. The completed redevelopment achieved the limited budget targets.

The redevelopment comprised:

- 200 seat social club
- refurbished bar facilities
- new amenities
- new commercial kitchen
- outdoor function area
- new glazed area for spectator viewing
- new accessible (compliant) lift



etchsport - Project Highlights



Existing conditions - before demolition

Rosedale Recreation Reserve - New Pavilion & Changeroom extension

ARCHITECTURE

Client: Wellington Shire Council
 Estimated Cost: \$975,000.00 AUD
 Period: August 2012 - current (under construction)
 Contact: John Tatterson (Manager Built Environment)

The project comprises of:

- redeveloped club house into sports change rooms (AFL specifications)
- administration area and time keeping box
- canteen with commercial kitchen
- bar facilities with cool room
- multi-purpose (social) room
- internal and external change facilities
- under cover spectator viewing area
- car parking

Etch was commissioned to redevelop and design a new sports pavilion incorporating part of the existing club rooms. This regional pavilion is to accommodate football, cricket, netball and the local field show.



Proposed extension - preliminary views 1



Proposed extension - preliminary views 2

etchresidential/community

Our expertise with community and education was launched with our understanding of our aquatic and sports experience.

Slowly we developed an understanding of the specific requirements to schools and community facilities including libraries to be able to design develop and complete multiple projects.

A lot of our knowledge came from multipurpose venues, for example Ruth Everuss aquatic and sports Centre in NSW, whereby the requirement was not only for a redevelopment of the existing aquatic facilities but also for the inclusions of sports hall stadiums public libraries cafes etc.

Therefore a similar type of technical knowledge is required found within the school and public community requirements.

We adopted our extensive knowledge of our previous projects and built up further knowledge of early childhood learning centres through to class room and pedagogical activities, implication for building design and functional learning layout (FLL).

In addition to our community facilities we have increased our knowledge through our departments and key staff of community housing and apartment housing along with boutique residential dwellings for private clients.

Our expertise with residential architecture comes from our deep and enthusiastic understanding of close relationships with our clients.

Not only understanding what our clients needs are but also understanding what we as residence ourselves would like to be surrounded by. Residential architecture is about understanding our clients lifestyle or the lifestyle portrayed in the finished product that is aimed to the developers market. Functional innovative and attractive abode with room and spacious living areas is what etch strives to achieve

AT Etch we have experience at designing living environments to suit specific conditions.

Fundamentally, our architecture is about designing and building homes, apartments units and aged care which are functional and safe. We think about prevailing building codes, safety issues, and functionality matters such as floor plans, placement of outlets, natural light ESD design and more importantly storage and circulation space. Our understanding extends to planning requirements res code and other building regulations including universal access (access to premise).

Through Greg Chateller and in association with Urban Design Architects, apartment and medium to high density housing has given Etch another discipline to which to add to our multi-discipline architectural projects. Greg's current completed residential project which is currently under construction was a complex development In Eaglemont Banksia Street apartments a 3 level 18 unit development. Independent of the residential housing Etch are currently completing an aged care facility (CLOVELLY COTTAGE).



etch residential/community

Etch key personnel have taken lead roles in the following listed projects:

Residential / Community

- Booroondara Council / Civic Centre Redevelopment
- Banksia Street apartments
- Gaffney Street Coburg Apartments
- Berrambool resort apartment and recreation facilities
- Market Street Nunawading Apartments
- Sandrige hotel
- Newmarkete Residential
- MS Society, Footscray Day Centre
- City of Greater Geelong - Council refurbishment / Customer Centre
- Wyndham Community Centre, Werribee VIC
- MS Society, Day Centre, Footscray VIC
- MS Society, Operations Centre, Blackburn VIC
- Kyneton Mechanic Institute, Library & Bowls Club
- Castella ' Central Park' - new landscape park (L)
- Sale Art Gallery / Library redevelopment (A+L)
- Shire of Wellington Civic Centre - redevelopment (A)
- Maffra Community Memorial Hall - refurbishment (A)
- Yarram Community Centre - master plan (A)
- Raymond Street - new covered pathway, Sale
- Scienceworks - new landscape redevelopment
- Mentone Uniting Church (A)
- Nunawading Community Centre - redevelopment (A+L)
- Kununurra 'Moon Experience' - music concert site planning and master plan, W.A (A+L)
- Flowerdale Community Centre - landscape works (L)
- Fairway - Day Care Centres - Asset Management audi
- Trevilli Contractors - Rosebud Townhouses (A+L)

Aged Care Facilities

- Amaroo Hostel, Dementia Wing, Ferntree Gully VIC
- Aged Care Services Australia, Kelaston Ballarat VIC
- Aged Care Services Australia - kitchen upgrade
- Catholic Homes for the Elderly, Clayton VIC
- Mercy Health Bethlehem, Bendigo VIC
- Baptcare Karingal, Devonport TAS
- Mountain View Retirement Village, Leongatha VIC
- Shanangolden ACF, Webster Way, Pakenham VIC
- Mingarra Retirement Village, Stage 9, Croydon VIC
- Cypress Gardens ACF, Greenmount WA
- Forest Gardens ACF, Waverley VIC
- Macloud ACR, 114-122 Somers Avenue, Macloud VIC
- Waverley Gardens, Bakers Road, Waverley VIC



etchresidential/community

Aged Care / Health Services

- Coleriane District Health - landscape works (L)
- Clovelly Cottage redevelopment (A+L)
- Bupa Templestowe - Aged Care Facility (L)
- Royal Flying Doctors Service - new admin facilities, Sale (A)
- Springvale Road - Glen Waverley - Medical Centre - landscape works (L)
- Clovelly Cottage aged care facility Boronia



Clovelly Cottage Aged Care Facility

Education

- Our Lady of the Way - Primary School (A+L)
- St. Lukes Primary School - new multi-purpose building (A+L)
- Bitten Primary School - BER masterplan (A)
- St. Mel's School, Shepparton - landscape works (L)
- St. Brendans Primary School, Shepparton - landscape works (L)
- Our Lady of Victories - landscape works (L)
- Yarra Road Primary School - BER landscape works (L)
- Yarra Road Primary - new staff administration wing (A+L)
- Yarra Road Primary School - new sports ground and landscape swale - landscape works (L)
- St. Joesph's School, Numerkah - landscape works (L)
- Nelson Park 'Special School', Geelong - landscape works (L)
- St. Timothy's School, Vermont - early learning centre master plan (A+L)
- Rushworth P - 12 - landscape works and play spaces (L)
- Dandenong High School - new entry courtyard and landscape works (L)
- St. Mary's, Shepparton - landscape works (L)
- St. Paul's. Monbulk - new classroom and administration wing (A+L)
- Phillip Island Nature Parks - Asset Management Audits for Penguin Parade & The Nobbies (Seal Rocks) (A)
- Bentleigh Optical Centre (A)
- Ascot Vale - Office development (A)
- The Melbourne Club - Kitchen redevelopment (A)
- Coles Supermarket, Cowes - landscape works (L)
- Burdens Plumbing, South Morang (A)



Our Lady of the Way - Primary School



St Mel's Primary School - new courtyard



Maffra Community Memorial Hall

etchcommunity - Project Highlights



St Brendans Primary School, Shepparton

ARCHITECTURE AND LANDSCAPE

Client: St Brendans Primary School
 (in association with Catholic Education Office)
 Budget: \$280,000.00
 Project Completion: March 2010

This project required the development of a suitable Masterplan and Design of a staged multi-functional external learning, play, functional and assembly spaces for children aged 5 – 12 years.

Works for this project included the redevelopment of all external spaces directly surrounding school buildings including:

- Provision of a courtyard space for the school's 'Building the Education Revolution' funded Senior Wing
- Redevelopment of the Senior School laneway and courtyard space sympathetic to the schools 'heritage' buildings
- Redevelopment of main asphaltic courtyard to provide spaces for community gathering & events, seating/waiting areas, external learning spaces, junior play space, eating areas, access throughout the site, enhanced drainage, and integration with the existing playground space.
- Provision of an external learning space suitable and specific to the school's Library/Resource buildings and Enhanced Learning Centre functions.
- Suitable spaces for site accessibility and amenities function
- Provision of a suitable and sustainable planting scheme which responded to site functions, design requirements for children's spaces, local environment and site conditions, relevance to the community, and implementation to provide an outcome sympathetic to adjacent contrasting contemporary and historical buildings.
- Staff & visitor car-parking



etchcommunity - Project Highlights



Sale Arts and Library Building

Client: Wellington Shire Council
Project: Public Art Gallery and Library Building,
 Council Office Relocation
Budget: \$20.0 million
Contact: Dr Glenys Butler

ARCHITECTURE

Etch was approached by Wellington Shire Council to produce a design concept study and future planning of a new Art Gallery and Library community facility between the existing Performing Arts Building and Council Civic Centre business precinct buildings.

The aim of the study was to link the two existing buildings with a new purpose-built facility dividing the zones of arts and public library spaces. The division was based on maintaining the split zones, library to council office siting and art gallery associated and link to the existing Performing Arts Building with a transparent spine with views to the existing Port of Sale and linkage to the port-side road access to facilitate and provide allowance for the port-side community hub master plan.

The building will house

- a cafe
- children's play area
- library
- offices
- meeting rooms
- 4 art exhibition spaces
- shared loading dock
- building footprint of approximately 4000sqm
- basement carpark, housing an additional 80 carparking spaces linked to the existing civic centre parking lot.



etchcommunity - Project Highlights



Sale Mall Redevelopment

MASTERPLANNING, ARCHITECTURE & LANDSCAPE

Client: Wellington Shire Council
Project: Completion: June 2011
Budget: \$1,000,000

As part of an Urban design competition, this project provides Conceptual Masterplan for the redevelopment of the Cunningham Street Mall.

The project required detailed site analysis, and extensive consultation with local authorities, community members and business groups to fully understand existing issues and desirable outcomes.

The consultation process aimed to provide outcomes for the site which enhanced use, business opportunities, flexibility, and desirability as a key space (for local/regional community and tourists alike) within the City of Sale.

The design outcome was required to provide a sense of connection and relevance to the Greater Region, and allow opportunities for further development of business and social opportunities within the City.



Director of Architecture



Sean Stone

Sean has over fifteen years of experience in all facets of architecture with a particular focus on design for community recreation (sport and aquatic facilities) and multi-discipline specialist building design.

With extensive experience gained through involvement with leading architectural firms Peddle Thorpe Architects, Prior & Cheney Architects (now Sutera) and Sinclair Knight Merz, Sean offers a broad range of expertise and industry experience including projects in recreation (sports and aquatics), community, defence/infrastructure, commercial and education.

In 2004, Sean was the Project Architect for the Award Winning Booroondara Sports Centre. The Sports Centre won the 2008 Metal Building Product Design Award from the Australian Steel Institute.

In 2006, Sean was a key figure in the successful bid for Wellington Community Indoor Sports Centre for SKM Wellington and Tennent Brown Architects, New Zealand. The renamed ASB Centre had been nominated and a finalist for an architecture NZ design award for the Wellington Region for 2013.

Also in 2006, Sean was invited by Life Saving Victoria to join the sub-committee to assist in revising and upgrading the Victorian Safe Pool Operation guidelines that will be incorporated into a National Design Standard for all public pools including apartments. This is an ongoing process.

The Sale Regional Aquatic Centre (of which Sean was the Project Architect) was awarded the 2009 Institute of Public Works Engineering Australia Victoria Division - Awards for excellence CAPITAL PROJECT AWARD

In 2012 Sean was invited to speak at the inaugural ARV Conference 'Narrowing the Gap Between Theory & Reality' - a residential workshop on pre-planning and designing recreation / sports facilities.

As Director of Architecture at Etch Architectural Solutions Pty Ltd, Sean leads the architecture and interior design team in all facets of project delivery.

The Etch Architecture Team prides itself on providing Clients the ability to:

- Design 'Greenfield Sites' and importantly, have the willingness and capability to tackle complex 'existing sites' and programmes
- Design existing facilities into revitalised and expanded forms
- Ensure all projects receive equal importance, be they in a metropolitan or regional location or interstate
- Provide a creative, yet commercial approach to all architecture - Beautiful and Functional
- Develop strong relationships with Clients as 'We Listen' and 'We Act'

"I like to provide opportunities for people to connect with the buildings and spaces we create. There is great pleasure in providing a facility that allows for the coming together of community, and for the achievements and well-being of the individuals within them"

Sean Stone - C.V

Sean Stone as Director of Etch Architectural Solutions Pty Ltd has over a decade of experience in sketch design, design development, design documentation, contract administration and project management across all facets of architecture, with particular focus on Sports & Aquatic Facility Planning, Defence Services, Community and Commercial. Sean facilitates the majority of Client liaison and undertakes the dissemination of work to the project team involved.

Position:
Director
Project Architect

Qualifications:
Bachelor of Architecture
Deakin University

Bachelor of Arts
(Architecture)
Deakin University

Business and Practice of
Architecture – R.A.I.A &
Deakin University

ARBV Registration No.
5678

NSW Registration No.
8054

Affiliations:
Australian Architecture
Association
Member No. 00561

Royal Australian Institute
of Architects
Corporate Member
Level 1

Associate Member
Aquatic Recreation
Victoria



Boroondara Sports Complex



Aqualink Nunawading



wangaratta

Key Project Experience:

July 2006 - current
Etch Architectural Solutions Pty Ltd
Please refer to Project Highlight pages for current experience

December 2004 – December 2006
Sinclair Knight Merz-Major Projects
Defence: HMAS CERBERUS, Small Arms Training Section (SATS).

SKM was appointed the Design Consultant for the project. Sean was the Design Manager up the completion of 90% Detailed Design (tender) stage of the project. He was the direct liaison with project manager's Connell Wagner and the Defence Support Group. This project was for the \$14.5m redevelopment of the existing 'heritage listed' Gunnery School on the BASE and the redevelopment for the existing firing range to a new DTAMS endorsed MTR range and two (2) pistol ranges.

Defence: West Head Gunnery Range, Flinders
SKM was appointed the Design Consultant for the project. Sean was the Design Manager up the completion of 30% Concept Design stage of the project. Sean was the direct liaison with project manager's Connell Wagner and the Defence Support Group. This project is for the \$13m redevelopment of the Fire Control Building with 'Grid' and the Training & Amenity Building. Sean has recently completed working as a consultant to SKM to assist the design into the second phase of the project delivery (50-90% detailed design).

Defence: Borella Club (Building 316), South Bandiana
SKM was appointed by Spotless Defence Services to detail design and assist with the contract delivery of the \$6m AUD Sports Club. Sean was the Design Leader and direct liaison with Spotless & Department of Defence.

Defence: Building 100 – North Bandiana
SKM was appointed by Spotless Defence Services to detail design and assist with the contract delivery of the \$4m Tank Facility. Sean was the Contract Administration reviewer to the Project Team.

Recreation: Sale Regional Aquatic Centre
Sean was the Project (Design) Architect for the \$6m redevelopment of the indoor swimming pool. The project included the inclusion of two new pools (leisure and hydrotherapy) and new dry facilities including café, admin, change, creche and a 400sq.m gymnasium.

November 1998 – December 2004
Prior + Cheney Architects (now Suters, Australia) major projects

Recreation: Boroondara Sports Complex
A new \$14.5m 4 netball court indoor sports centre with an additional (redeveloped) 50m outdoor swimming pool

and associated facilities.
Project Role: Technical Project Co-ordinator, design, documentation, and specification.
Client: City of Boroondara

Recreation: Aqualink Nunawading (Fitness & Aquatic Centre)
Redevelopment of the existing 50m swimming pool hall and pool, including a new 400sq.m gymnasium and dry change facilities. (\$6.5m).
Project Role: Project Leader, Design, Documentation and Specification.
Client: City of Whitehorse

Community/ Education: New Manufacturing / Technology Wing. Sunbury Secondary College
Estimated Cost: \$2.5m (Stage 3)
Project Role: Superintendent. Project Co-ordinator including design, documentation and specification.
Client: Sunbury Secondary College / Dept of Education

Recreation: Wangaratta Indoor Sports & Aquatic Centre (HP Barr Reserve)
The \$5m redevelopment of the existing basketball stadium with the inclusion of aquatic facilities (25m pool, program and leisure pools) and gymnasium.
Project Role: Project Leader, Design, Documentation and Specification. RCoW was the Superintendent – assisted in Design Intent and technical / construction queries / defects observations.
Client: Rural City of Wangaratta

- Other significant projects include:
- Imaroo Hostel, Dementia Wing, VIC
 - Maribyrnong Aquatic Centre, VIC
 - Penrith YMCA Stadium, NSW
 - Kurri Kurri Aquatic Centre, NSW
 - Imaroo Community Centre, VIC
 - M.S Society – Footscray Day Centre, VIC
 - Enfield Aquatic Centre – masterplan
 - Gisborne Aquatic Centre – masterplan
 - Seymour Aquatic Centre, VIC
 - Raymond Terrace Aquatic Centre, VIC
 - Clayton North Primary School, Stages 1,2&3
 - Doncaster Aquarena – Family Change

August 1997 – October 1998
Sneath & King Architects:

Commercial: Melbourne International Airport Level 2 operations centre fit out proposal.
Project Role: Documentation and Joinery Design
Client: Ansett Australia Pty Ltd

Commercial: Volkswagen & Kia Car Showrooms
Sean was involved in the design of the new \$2.5m car showrooms at Geoff Brady Motors.
Project Role: Project Co-ordinator to the Directors, Documentation and Design.
Client: Geoff Brady Motors & APM Group

January 1996 – August 1996
Peddle Thorp Architects:

Community: The Alfred Deakin Centre, Mildura
The new \$10m Information Centre, Library and Aquatic Centre.
Project Role: Documentation.
Client: Mildura City Council

Senior Architectural Project Leader



Greg Chatelier — Architecture

Greg Chatelier, as a Company Director of Santel Architects and Project Manager and Senior Project Co-ordinator at Tompkins Shaw & Evans Architects, brings over 15 years experience in strategic planning, design development, construction and contract administration through to project completion. Greg's expertise includes sports, recreation, industrial, defence, Government/ Local Government, retail and cinematic design.

Extensive experience as a Project and Contract Administrator, (with clients including the Melbourne Cricket Club, Ford Australia and retailers such as Lend Lease and Centro Properties) has provided Greg with the skill set to successfully manage multiple venues, stakeholders, clients and user groups from design through to completion - within budget and timeframe.

One example of this would be the Melbourne Cricket Club project which involved numerous stakeholders, user groups, sub-contractors and consultants within a very complex and difficult environment. Strict deadlines included the broadcast of weekend matches and crowd attendance of approximately 70,000 people at any given time. Successful completion involved not only the project itself but a safe environment for public attendance as well as ensuring available services for the broadcasting of multiple media groups for weekend matches.

Part of the role as MCC Architect not only involved the designing of buildings and improving facilities but also assisting the facilities and venue management departments in running the maintenance of not only the MCG but the sections and affiliated sites such as:

- Junction Oval, Albert Ground, Punt rd Oval, MCC Baseball Pavilion, Hawthorn Bowls club,
- Multiple gymnasiums and squash court facilities and many other sites.

Other projects undertaken include:

- Sunshine Cinemas & Entertainment
- Eastland Shopping Centre
- Acland Court Shopping Centre
- Resort & Retail, Park Meadows
- Townsville Cinemas

Greg extends Etch's ability to run projects to strict budgets and timelines with design expertise in sports and recreation, retail and cinemas. With a detailed knowledge of construction, planning and co-ordination of consultants, clients and stakeholders Greg is a vital member of the Etch team.

Greg, like Sean, brings passion, knowledge and experience in sports, recreation and community facilities Greg has introduced retail and cinematic design to Etch's capability. Bringing knowledge of Shopping Centre and retail planning work, as well as cinematic design, from screen sight lines, position and distortion ratios, sound, acoustics and seating plot design standards.

His technical knowledge and design experience diversifies Etch's architectural range of experience.

In general Greg's areas of expertise include.

- Sports & Recreation
- Retail
- Master planning resorts, hotels, high density accommodation
- Urban Planning
- Industrial
- Cinematic Design
- Exhibition Design
- Medium to low density Residential

There are many facets and considerations to a well planned and functional architectural building. Interest in an attractive design creates an element of intrigue that the public and user groups should be drawn to while absorbing the environmental surround.

Greg Chatelier - C.V

Greg Chatelier, as Company Director of Santel Architects and Project Manager and Senior Project Co-ordinator at Tompkins Shaw & Evans Architects has gained over 15 years experience in strategic planning, design development, construction & contract administration through to project completion. Particularly in the sports, recreation, Local Government municipals industrial and commercial architectural industries.

Vast experience as a Project and Contract Administrator mainly with the Melbourne Cricket Club & Ford Australia and retailers such as Lend Lease and Centro properties has allowed Greg to be able to manage multiple venues, stakeholders, clients and user groups successfully from design to completion and within budget & time frame. Greg has also used this experience to gain knowledge of the construction process and time frames as well as dealing with builders, contractors and user groups.

The Melbourne Cricket Club is a fair example of this, as there were many stakeholders, user groups, sub-contractors and consultants involved, with a very complex and difficult environment, along with strict deadlines involving the broadcast of weekend matches and crowd attendance of approx 70,000 people at any given time, a successful completion involved not only the project itself but a safe environment for public attendance and available services for broadcasting of multiple media groups to be able to broadcast the weekend matches.

Greg's role as the preferred MCC (Melbourne Cricket Club) Architect and Assistant Facility Department Project Manager spanned for over 10 years, which included working closely with various departments of the MCC including Facilities, Venue & Operations, Finance, Events & Ticketing, MCC Trust & Committee, Marketing, OH&S and MCC Administration (including close relationships with Mr Scott Butler and Mr Stephen Gough). The role also involved working closely with the 200 staff and contractors that were part of the MCC team. These included: builders, IT, electrical, mechanical, hydraulic, fire services, signage, ticketing, stakeholders including AFL, Sports Ready, Football Victoria, Cricket Victoria, Football Federation (Soccer), Tennis Australia, Victoria Police, St John's Ambulance, Commonwealth Games, Socog, Melbourne Football Club, Collingwood Football Club, West Coast Eagles, Richmond Football Club, North Melbourne Football Club, Telstra, Global TV Channels 9, 10 & 7 and various radio stations.

Part of this role as MCC Architect not only involved the designing of buildings and improving facilities but assisting the facilities and venue management departments in running the maintenance of not only the MCG but the sections and affiliated sites.

Key Project Experience:

2012 - Current
Etch Architectural Solutions
 Please refer to Project Highlights

2011 - 2012.

Urban Design Architects

Project Description/Role:
 Multi-level apartment buildings - medium to high density residential buildings and housing.
 Tasks included - design development, Town Planning, Rescode, detailed documentation and project management

2008 - 2011

Self employed in association with Tompkins MDA Architects (Bill Kent and Brian Smith)

Project Description/Role:
 A major Government project for ARPANSA (Australian Radiation Protection & Nuclear Safety Agency) which involved a laboratory and office extension. The project included complete design concept stages, cost planning, staging, along with full documentation, detailed design and tender packages. Client liaison and briefs, consultant and sub-contractor briefs, shareholder/stakeholder meetings along with environmental sustainability design, building forms, future expansion planning and regulatory requirements were all coordinated and undertaken. Post-tender consultancy was also provided

2007

Graeme Law & Associates

Project Description/Role:
 Project management and documentation for Catholic Education Projects - Churches and Schools
 Projects included:
 Damascus College Ballarat
 St Macartens School (new school on a green field site)
 Michael Waddington (new \$1.0m residential development)
 Queen Victoria Market (retail & main mall fit-out design)

2005 - 2007

Santel Architects, Director

Project Description/Role:
 As MCC Club Architect and project Venue Manager, the project included involvement with the Architectural Consortium for the New MCG Northern Stand, which included major staff relocations throughout the 5 year project, relocating state cricket to alternate venues and assisting the MCC departments in co-ordinating staff and contractors for the preparation of the Commonwealth Games in 2006

1992 - 2005

Tompkins Shaw & Evans Architects (East Melbourne)

Project Description/Role:
 As MCC Club Architect, the project involved design documentation, specifications and project management for clients such as Lend Lease, Coles Myer, Bosch and close relations with Ford Australia.

As Team Leader and lead Project Manager, extensive experience with Local Government and projects including aquatic centres, master planning, urban planning and technical knowledge in aquatic centre procedures and facility management was gained. Marketing procedures and company development was also part of this role

1990 - 1992

Metier III Architects - Architects & Planners

Project Description/Role:
 Commercial architectural project including high-rise office building for the T&G Building - 151 Collins Street, Melbourne. Works included design and documentation tasks

Position:
 Senior Project Architect

Qualifications:
 Bachelor of Architecture

Associate Diploma
 of Applied Science
 Architectural Drafting



Emerton Aquatic Centre



MCG - External Model



MCG - Northern Stand

References

Wellington Shire Council Projects

Mr Chris Hastie
 General Manager - Built Projects
 Wellington Shire Council
 ph: (03) 5142 3324
 email: chris.hastie@wellington.vic.gov.au

Mr Daniel Kaegi
 Project Manager – Team Leader
 Aurecon Australia Pty Ltd
 (Formerly Connell Wagner)
 ph. (03) 9697 8444
 m. 0401 488 075
 email: kaegid@ap.aurecongroup.com

Gippsland Regional Indoor Aquatic Centre

Mr Jamey Mullen
 Manager - Healthy Lifestyle and Recreation Services
 LaTrobe City Council
 ph. 03 5128 5629
 m. 0408 523 747
 email: jamey.mullen@latrobe.vic.gov.au

Wellington Indoor Community Sports Centre (New Zealand)

Mr Jamie Delich
 Manager - Recreation Wellington
 Wellington Shire Council
 ph: + 64 4801 3218
 email: jamie.delich@wcc.govt.nz

Aquatic & Recreation Victoria

Mr Ian Swan
 Chief Executive Officer
 ph: (03) 9271 3800
 m: 0419 489 594
 email: iswan@aquaticsandrecreation.org.au

Autumn Care Properties

Mr Ross Ferris
 Chief Executive Officer
 ph: (03) 9762 4217
 m: 0400 100 359
 email: ross.ferris@autumncareac.com

Yarra Ranges Council

Ms Julee Scott / Mr Ben Bainbridge
 Shire of Yarra Ranges
 ph: (03) 9294 6758
 m: 0419 489 594
 email: b.bainbridge@yarraranges.vic.gov.au

@Leisure Recreation Planners

Ms Sally Jeavons
 Director
 ph: (03) 9329 1662
 email: sally@atleisure.com.au

Catholic Education Office

Mr Richard Anderson
 Project Manager
 ph. (03) 9267 0555
 m. 0427 411 058
 email: randerson@ceomelb.catholic.edu.au

Gippsland Regional Sports Centre & Sale Regional Aquatic Centre

Mr John Tatterson
 Manager - Built Environment
 Wellington Shire Council
 ph: (03) 5142 3475
 email: john.tatterson@wellington.vic.gov.au

Defence Projects – Aurecon



FEE PROPOSAL

QUANTITY SURVEYING SERVICES

**PORT HEDLAND COMMUNITY
PLANNING (OPEN SPACE AND
INFRASTRUCTURE) MASTER PLAN**

Our Ref: Q1414236



trevormain

PROPERTY AND CONSTRUCTION SOLUTIONS

Level 3
468 St Kilda Road
Melbourne VIC 3004

FOR

etchARCHITECTS

10 APRIL 2014

2.0 OUR TEAM

KEY MANAGERIAL AND SUPERVISORY PERSONNEL

Trevor Main now employs 30 staff in Victoria. Key team members for this project will be:

- Jason Flentjar, Associate Trevor Main VIC
- Trevor Phillips, Director Trevor Phillips and Associates WA

The above key members will be supported by additional team members as required.

KEY TEAM MEMBERS

Jason Flentjar AAIQS

Jason is an Associate of the Trevor Main Group and will be the Project Team Leader. He has had over 20 years experience in the industry across all facets of Quantity Surveying. He will support Trevor in management of day – to – day activities on the project, and will lead the cost planning activities.

Jason has experience in cost planning and administration of a wide variety of building projects around Australia including a number of sport and recreation projects such as:

- Kununurra Leisure Centre and Sports Fields Masterplanning.
- Newman Recreation Masterplan.

His role on the project will be:

- Attendance at Consultants meetings;
- Overall management of the Trevor Main team;
- Preparation and review of all costing and reports;
- Advice on contractual matters, tender strategies and the like;
- Provision of cost advice on options, alternative materials and construction methods.

Trevor Phillips LFAIQS

Trevor is the Director of Trevor Phillips and Associates, who will provide the local market expertise and work closely with Jason to provide accurate up – to – date cost advice.

Trevor has over 40 years in the industry as a professional Quantity Surveyor and has recently been involved with several local Government projects such as:

- Port Hedland Youth Centre;
- City of Canning Sports Pavilions;
- Town of Kwinana Youth Centre;
- Port Bouvard Surf Life Saving Club for City of Mandurah

3.0 PROJECTS

3.1 SPORTS AND AQUATIC PROJECTS

Trevor Main and its staff have successfully completed a number of Sports and Aquatic Projects around Australia. These include:

Glen Eira Sports and Aquatic Centre (image below)



Ballarat Aquatic Centre (50m indoor pool extension)

Bairnsdale Outdoor Pool

Shepparton Stadium Extension

Macedon Ranges Regional Netball Centre

Romsey Aquatic Centre

Frankston Regional Aquatic Centre

Kyneton Sports and Aquatic Centre

Gisborne Aquatic Centre

Nunnawading Leisure Centre

Caroline Springs Stadium

Diamond Creek Stadium

Werribee Sport and Fitness Centre

Cardinia Life Aquatic and Leisure Centre

Gippsland Regional Aquatic Centre (Traralgon)

Bairnsdale Aquatic and Recreation Centre

Lilydale Secondary College Sports Stadium

Scovell Reserve Sporting Pavilions

Bass Coast Aquatic and Leisure Centre Redevelopment

We have provided Quantity Surveying Services on the following Sports and Aquatic Facilities around Australia:

Kununurra Leisure Centre Feasibility Study (WA)

Newman Aquatic and Leisure Masterplan (WA)

Ruth Everuss Aquatic Centre (NSW)

Penrith Swimming Centre (NSW)

Wagga Wagga Multi Purpose Stadium (NSW)

Ripples Leisure Centre (NSW) (image below)



A more detailed list of projects is available from our office at your request.



Jeavons
LANDSCAPE ARCHITECTS



PRACTICE PROFILE

1st Floor 717 Nicholson Street Carlton North Vic 3054 Australia
9387 7337 info@jeavons.net.au www.jeavons.net.au



OVERVIEW

Jeavons Landscape Architects is an award winning, landscape architectural practice, known for our high quality, detailed and customised landscape design in natural environments, parks, children's spaces, sensory gardens and other sites in the public domain.

We work in urban and rural settings all over Australia. Our designs respond to the people, landscapes, environments and circumstances to create thoughtful, unique outcomes for every project.

With more than 25 years experience in our field we have developed skills in working with numerous community groups and individuals on important, unique and complex projects.

Our clients include local and state government authorities, schools, the early childhood sector, health and aged care facilities and community groups. We frequently collaborate with a wide range of other professionals including recreation planners, architects, artists, engineers, planners, ecologists, quantity surveyors and cultural advisors.

Formerly known as Mary Jeavons Landscape Architects, our trading name changed to Jeavons Landscape Architects in April 2011.



Clifton Hill Rail Duplication Project
Winner: AILA Vic. Urban Design Award 2011, AILA National Design Award 2012
BPN (Building Product News) Sustainability Awards, Landscape Design Award 2012

SERVICES

Jeavons Landscape Architects work across a broad spectrum of project areas within the field of Landscape Architecture. Our work includes strategic and master planning and design in public places and community spaces, environmental projects, education and therapeutic settings, detailed landscape designs, and play spaces of all sizes for all abilities including;

Landscape Architecture in the Public Domain

Fresh, considered and bespoke landscape design, master plans, concept designs and detailed documentation drawings

Working with Natural Environments

Planting designs, sensory gardens, ecological restoration, Water Sensitive Urban Design

Broad scale Landscape Planning

PlaySpace Strategies for entire municipalities; Landscape master plans for whole parks and reserves; policies, feasibility studies and reports

Accessible design

Fully integrated accessible and inclusive landscapes and play environments

Design for Children

Acknowledging children in the public domain, as well as design of local, district and regional public play spaces, schools and early childhood centres

Risk and Safety Standards

Applying our expertise in Safety Standards to public landscape and play space designs

Design for Sport and Recreation

Working with @leisure planners designing integrated landscape solutions for sports precincts, open space, BMX and skate facilities and whole park master plans

Consultation and Collaboration

Consulting communities and collaborating with artists and professionals

Servicing Remote and Rural Communities

Landscape architectural services Australia wide

Education and learning environments

Jeavons Landscape Architects draw on the research of learning specialists, current theories and best practice in education and child development



Growing Wild Stage 2: main gathering space within new Ground Zone precinct (2012), Melbourne Zoo

DESIGN EXPERIENCE

Our designs aim to maximise the aesthetic qualities of every space and to provide an underlying functionality, reflecting the importance of physical and social access, fitness for purpose, practicality of maintenance and environmental sustainability.

Strategic and Master Planning

Our planning perspective helps clients to maximise the long term social and physical value presented by every site.

Broadscale Strategic Plans and Site Master Plans

- Strategic developments which establish ecological, design, artistic, play and recreation links, setting a framework for more detailed design.
- Master plans for whole parks, sites and regions, school grounds or distinct precincts, addressing landscape, amenity and circulation, play and recreation, planting, and specialist issues such as bike paths, revegetation and animal management.

Play Space Strategies

Jeavons Landscape Architects have an unmatched core of expertise in strategic thinking on open space and play space development, promoting a vision for children, youth and families.

Public Parks and Play Spaces

Jeavons Landscape Architects design unique, fun and inclusive play spaces of all sizes and budgets in parks all over Australia. Our thoughtful designs consider the whole park as a play setting. Open areas, paths and vegetation are balanced with multi-purpose play activities, equipment, and natural and artistic elements as required, to suit age groups, budgets and the client's needs.

All - abilities, contemporary design

Our designs are multi layered and seek to engage children over time, providing choices of physical activity, challenge, creativity, imagination and social activities for all ages. Our staff have pioneered the design of accessible inclusive play spaces that welcome and stimulate children and adults with disabilities in public play spaces of all kinds, as well as special schools and all other schools and early childhood projects.

Sensory Gardens

These spaces are purposefully designed to heighten the sensory experiences of children and adults. We work with therapists and other staff to create artistic and beautiful spaces with texture, colours, scent and sounds, spatial variety, thermal properties and movement.



Craigieburn Gardens Masterplan

Location: Craigieburn Road, Craigieburn
 Client: Hume City Council
 Designed by: Jeavons Landscape Architects with @Leisure, 2011
 Status: Completed, endorsed by Council 2012

Craigieburn Gardens is a significant outdoor space located in the 'older' part of Craigieburn. The site is located on a former landfill site, adding another layer of complexity to the design process.

The site consists of the Leisure Centre, providing users with indoor fitness activities such as basketball, swimming and gym facilities, a Council customer service centre, library, youth centre, SES, kindergarten and an open space over the landfill site. As part of the new Craigieburn Town Centre, some of these services will be relocated and Council required a long term Masterplan for the development of the site.

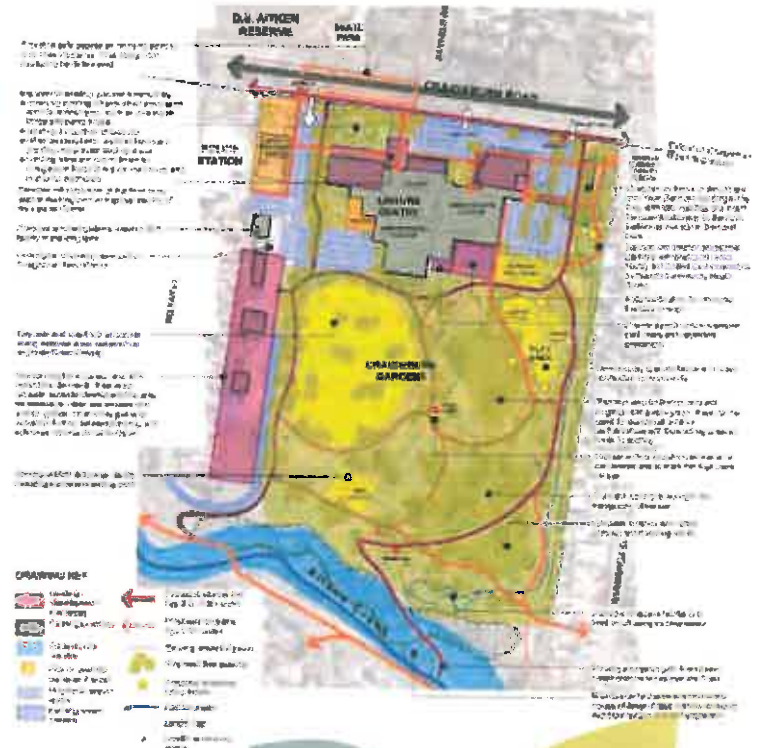

The design called for revitalisation of the Leisure Centre so it can continue in its role providing leisure activities for local residents. A series of extensive consultations meetings were undertaken with Council officers, community stakeholders and community groups. The wider community were also consulted through letter drops, Council's website and a walk and talk day on site. The findings of the consultation provided us with the direction to generate a Masterplan that would be acceptable by all parties.



The Jeavons team worked with Traffic Engineering consultants (O'Brien Traffic) to resolve the current and future car parking on site, improve pedestrian safety movement in and out of the site as well as improve internal and external vehicle movement.



Examples of selected relevant projects



BALLAM PARK MASTERPLAN, FRANKSTON

Frankston City Council

Jeavons Landscape Architects were engaged to prepare a Masterplan that resolves carparking and traffic issues surrounding the existing sport grounds. The design of the Masterplan involved works to:

- design a schematic road layout
- rationalise the car park areas whilst identifying overflow carparking areas
- retain country character by allowing carparking around the sport grounds
- identify internal path linkages from the new car park areas
- provide a recreational gathering space

The Masterplan was completed August 2008.

ROY DORE RESERVE MASTERPLAN, CARRUM

City of Kingston

Jeavons Landscape Architects worked in collaboration with O'Brien Traffic Engineering to design the Masterplan. The process required us to:

- provide a schematic design for the road layout
- resolve the north and south car park layouts
- retain country character by allowing carparking around the ovals
- identify overflow carparking areas
- provide internal and external path linkages
- reinforce tree planting character on the site
- provide a consistent suite of park furniture
- consult with the client and stakeholder groups

The Masterplan was completed June 2010 and construction is expected to be completed by the end of 2011.

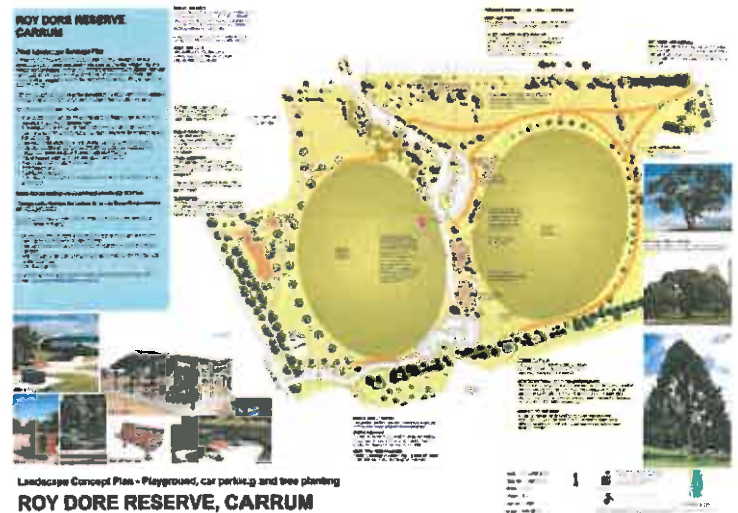

SOVEREIGN HILL POST OFFICE POND MASTERPLAN, BALLARAT

Sovereign Hill Museums Association

The Master Plan has been commissioned as part of the refurbishment works of the kiosk. The Master Plan provides an accessible looped walking trail with formal bluestone edging, natural embankments and timber boardwalks to interact with the pond. The looped walking trail also forms an informal discovery trail to tie in with the play values of the new playground.



Mentone Foreshore Masterplan

Location: Mentone Foreshore Masterplan, Charman Rd to Naples Rd
 Client: City of Kingston
 Designed by: Jeavons Landscape Architects
 Status: Draft with Council 2014

Jeavons Landscape Architects were engaged by City of Kingston to develop a Masterplan for the Mentone Foreshore Precinct from Charman Road to Naples Road.

The Masterplan design focuses on:

- Identifying the alignment of the Bay Trail to improve pedestrian and cyclist safety along Beach Road
- Providing all ability access from Beach Road to the foreshore
- Improving the amenities at the Mentone Life Saving Club in particular carparking, all ability access and recreational activities
- Connecting and providing safe access from the Life Saving Club carpark to the existing playspace
- Continuing and improving stormwater and vegetation management
- Designs that are empathetic to the sensitive coastal environment

Jeavons worked closely with @Leisure to undertake community consultation as well as O'Brien's Traffic Engineering to resolve the carpark design. The Draft Masterplan is currently being reviewed by Council.

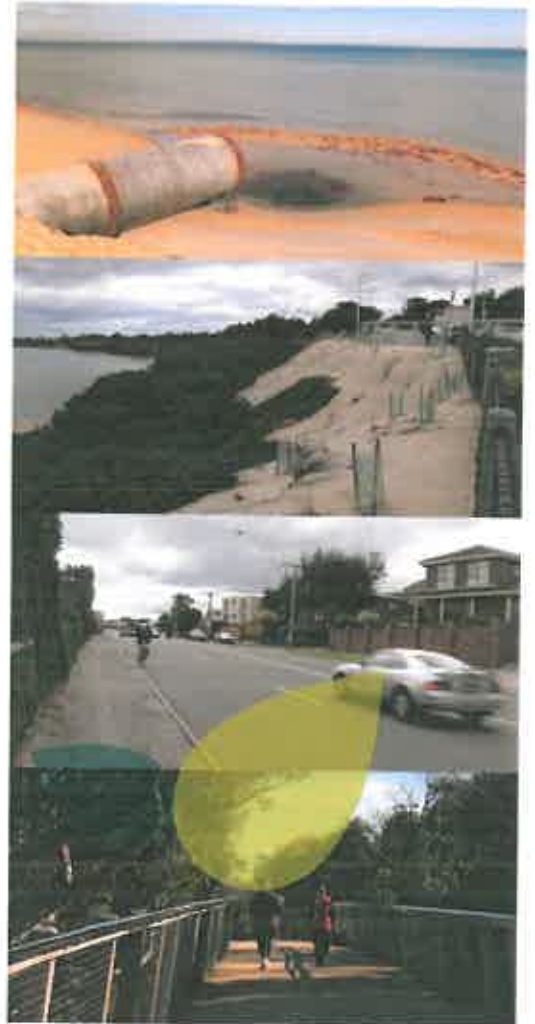

Wesley College Landscape Management Strategy

Location: Wesley College, Glen Waverley Campus

Client: Wesley College

Designed by: Jeavons Landscape Architects

Status: Endorsed, December 2013

The project was originally initiated because of the need to manage changes in the vegetation and tree planting on this site. The strong Australian native theme in the planting is generally highly valued and remains a strong identity for this campus. Over time, however, some trees have caused problems for buildings and drains, and many trees have already been removed. Rather than adopt an ad hoc approach to replacements, the school has taken the initiative to think and plan strategically, recognising the importance of the school landscape and its contribution to the philosophy and purpose of this Wesley School.

Jeavons staff collaborated with school staff and the grounds crew to produce the Landscape Management Strategy report. The aim of this document is to:

- Assess and discuss current development constraints on the campus
- Prepare general guidelines for tree planting and garden beds across the campus
- Prepare guidelines for access and circulation, furniture and hardscape elements that form part of the whole campus landscape
- Review the junior, middle and senior zones within the campus and make general recommendations regarding future works in these spaces.

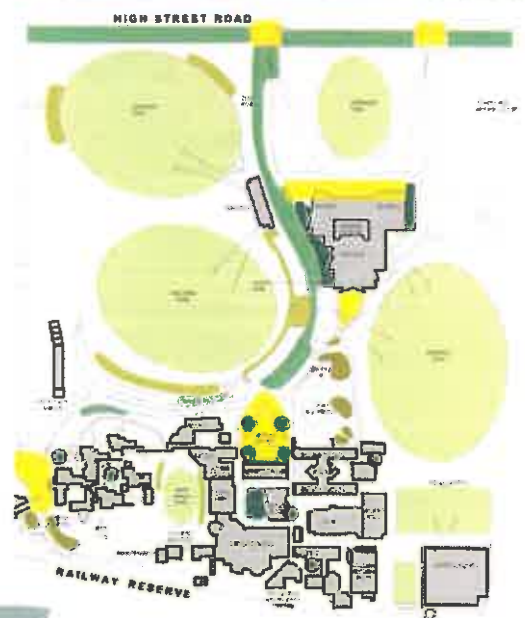

BUSINESS CAPACITY

Jeavons Landscape Architects

Mary Jeavons is the company director and is actively involved with the practice. Mary is a Fellow of the Australian Institute of Landscape Architects and a member of the Playground Standards Committee. She leads a team of highly qualified professionals including,

- senior landscape architects / designers, all with more than 10 years experience
- qualified horticulturists
- experienced CAD drafts people skilled in the production of high quality plans and drawings

Jeavons staff are members of a number of professional organisations including the Australian Institute of Landscape Architects (AILA), Parks and Leisure Association of Australia (PLA), Playgrounds and Recreation Association Victoria (PRAV), Association of Consultants in Access Australia (ACAA) and the Victorian Employers Chamber of Commerce and Industry (VECCI). Our staff have presented papers at numerous seminars and conferences run by these organisations.

Insurances

Jeavons have current:

- Public Liability Cover to \$20,000,000.00
- Professional Indemnity Cover to \$10,000,000.00
- All staff are covered by Work Cover policies and Superannuation Guarantee levy

